

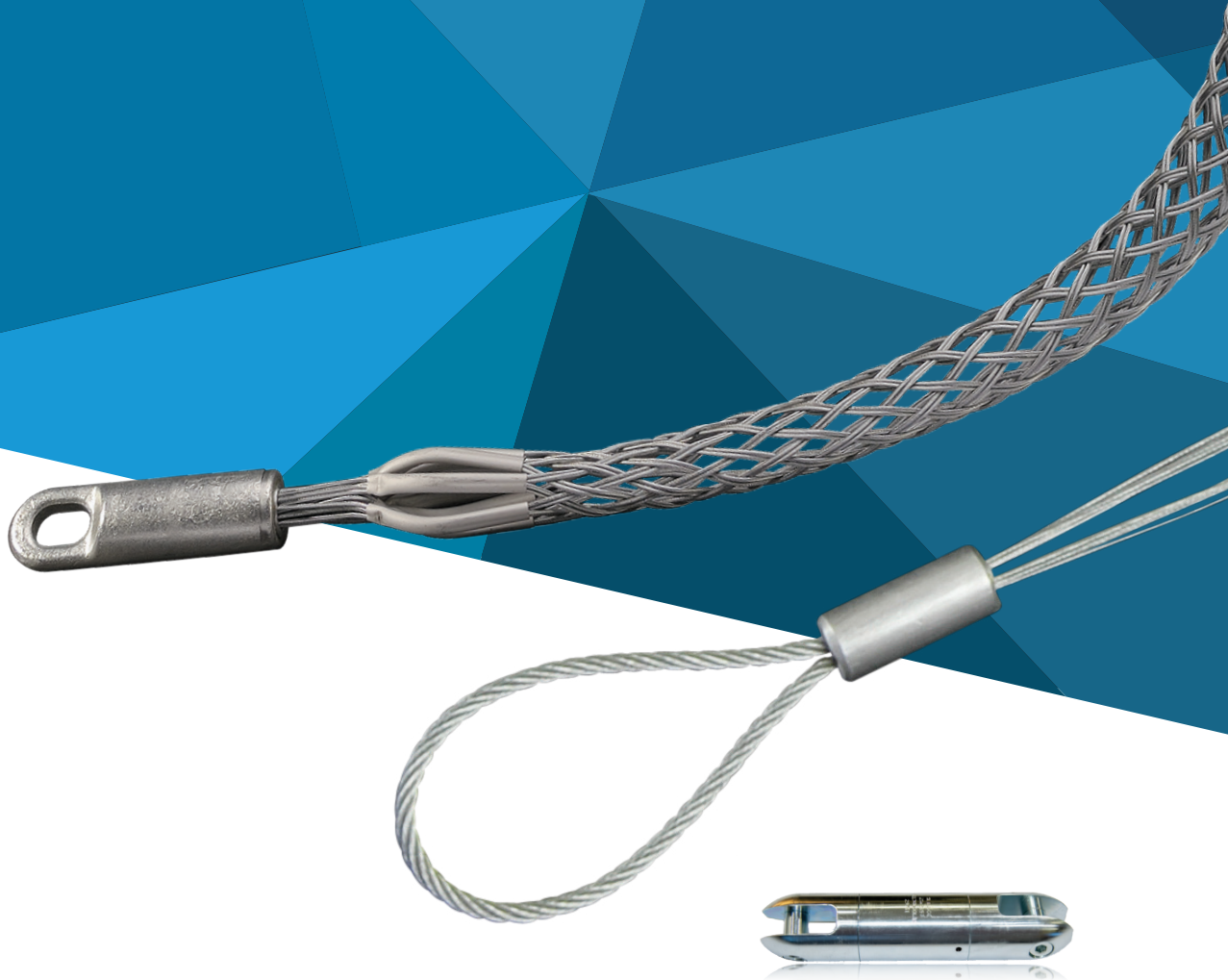

# MESH GRIPS

PROVIDING THE SUPPORT YOU NEED



**CABLE PULLING**

A Type – High Strength Cable Grip ..... 2  
 MU Type – High Strength Cable Grip ..... 2  
 ST Type – Single Eye Double Weave Cable Grip..... 4  
 SE Type – Single Eye Cable Grip ..... 4  
 Junior Type Cable Grip..... 4  
 Fiber Optic Cable Grip..... 5  
 OS Type – Offset Eye Cable Grip ..... 6  
 L Type – Lace Up Cable Grip..... 6  
 DE Type – Double Eye Cable Grip..... 10

**UNDERGROUND CABLE GRIPS**

R Type – Rotating Eye Multi-Weave Cable Grip ..... 7  
 RT Type – Rotating Eye Double Weave Cable Grip ..... 7

**SPLICING CABLE GRIPS**

Open-Ended Cable Grip ..... 8  
 Splicing Grip – Rotating Swivel Link ..... 9  
 Splicing Grip – Rotating Barrel..... 9

**HOSE RESTRAINT & HEAVY DUTY LARGE DIAMETER CABLE GRIPS**

Hose Restraint Heavy Duty Grip..... 10  
 Marine Cable Grip ..... 11

**NON-METALLIC (ARAMID) CABLE GRIPS**

NS Type – Non-Metallic (Aramid) Single Eye Cable Grips..... 12  
 ND Type – Non-Metallic (Aramid) Double Eye Cable Grips.... 13  
 NO Type – Non-Metallic (Aramid) Offset Eye Cable Grips ..... 13

**CABLE CONTROL AND GUIDANCE/ACCESSORIES**

Feed Tube for A Type Grips ..... 2  
 Anti-Rotational Device..... 5  
 Figure 8 ‘Swing Link’ Connector..... 9  
 Cable Laying Roller Grip..... 24  
 Tri & Quad Pulling Sling Grip ..... 24  
 Tools, Buckles, and Bands ..... 26 - 27  
 Reel Lifter ..... 28  
 Hand Line Tools..... 28  
 60-Ton Hydraulic Crimping Tools ..... 29  
 Mechanical Crimping Tools ..... 29

**LINE PULLING SWIVELS/ACCESSORIES**

Line Pulling Swivel – Bright Zinc Plated Steel ..... 3  
 Line Pulling Swivel – Galvanized ..... 3  
 Swivel and Connector Grip/Replacement Pins ..... 3  
 Connectors: 90°, Rope to Rope, Rope to Swivel..... 8

**CABLE SUPPORT**

Wind Turbine Support Grip  
 Heavy Duty Thimble Offset Eye Grip ..... 25  
 Extended Thimble Eye Heavy Duty Double Weave  
 Stainless Steel Cable Grip ..... 25

**STANDARD DUTY SUPPORT GRIPS**

Single Eye Closed Mesh Cable Support Grip ..... 14  
 Single Eye Split Mesh Lace Closing Cable Support Grip..... 14  
 Single Eye Split Mesh Rod Closing Cable Support Grip ..... 14  
 Double Eye Closed Mesh Cable Support Grip ..... 15  
 Double Eye Split Mesh Lace Closing Cable Support Grip ..... 15  
 Double Eye Split Mesh Rod Closing Cable Support Grip ..... 15  
 Offset Eye Closed Mesh Cable Support Grip ..... 16  
 Offset Eye Split Mesh Lace Closing Cable Support Grip ..... 16  
 Offset Eye Split Mesh Rod Closing Cable Support Grip ..... 16  
 Universal Eye Closed Mesh Cable Support Grip ..... 17  
 Universal Eye Split Mesh Lace Closing Cable Support Grip... 17  
 Universal Eye Split Mesh Rod Closing Cable Support Grip.... 17  
 Conduit Riser Stainless Steel Cable Support Grip..... 20

**HEAVY DUTY SUPPORT GRIPS**

Heavy Duty Support Grips – Single Eye ..... 18  
 Heavy Duty Support Grips – Single Eye Lace-Up..... 18  
 Heavy Duty Support Grips – Single Eye Rod Closing..... 18  
 Heavy Duty Support Grips – Double Eye ..... 18  
 Heavy Duty Support Grips – Double Eye Lace-Up..... 18  
 Heavy Duty Support Grips – Double Eye Rod Closing ..... 18  
 Hooked Eye Conduit Cable Support Grip..... 20

**LIGHT DUTY SUPPORT GRIPS**

Bus Drop Cable Support Grip ..... 19  
 Service Drop Cable Support Grip ..... 19  
 Nylon Support Grip for Fiber ..... 19

**SPECIALTY CABLE MANAGEMENT SUPPORT GRIPS**

Connector/Box Stainless Steel Grip ..... 21  
 Deluxe Cord Grip..... 22 - 23  
 Dust-Tight Cord Grip ..... 23

**POLE LINE HARDWARE**

Pole Line Suspension Clamps ..... 30

**IMPORTANT TECHNICAL INFORMATION**

Swivel and Cable Grip Match-Up ..... 3  
 Cable Pulling Grips and Cable Support Grips ..... 31  
 Single and Double Eye Cable Grip Installation Instructions... 32  
 Lace Up Cable Grip Installation Instructions ..... 33

**A TYPE**  
High Strength • Cable Grip

Ideal for pulling heavy loads  
This strong grip is perfect for any application with heavy load ratings such as overhead transmission, distribution line, electric railroad, gas, rigging line, and construction pulling.

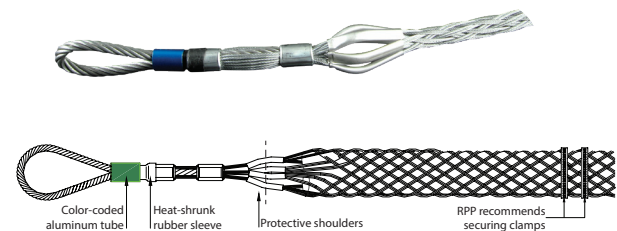

**MU TYPE**  
High Strength • Cable Grip

Ideal for pulling medium to heavy loads  
This cable grip has a flexible eye, is color-coded for easy identification, and is perfect for stringing heavy load pulls. Use with bare or insulated cable, conductor, or wire.

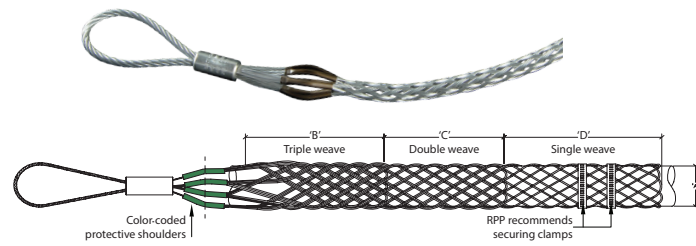

**A Type - High Strength Cable Grip**

Part #	Stock Code	Color Code	Rope Diameter Range		Conductor Diameter Range		Overall Length		Lattice Length		Approx. Break Load	
			in	mm	in	mm	in	mm	in	mm	lb	kg
RPP1799	0544-5033	Black	0.25 - 0.65	6 - 16	0.19 - 0.40	5 - 10	38	965	28	710	7,000	3,180
RPP3020	0544-5036	Purple	0.30 - 0.40	7.5 - 10	0.25 - 0.40	6 - 10	42	1,067	30	760	10,000	4,530
RPP1800	0544-5039	Dark Green	0.50 - 0.90	13 - 23	0.38 - 0.63	9.7 - 16	51	1,300	37	940	14,000	6,360
RPP3522	0544-5042	Grey	0.44 - 0.90	11 - 23	0.44 - 0.63	11 - 16	110	2,800	97	2,470	20,000	9,072
RPP1801	0544-5045	Red	0.75 - 1.10	19 - 28	0.63 - 0.88	16 - 22	74	1,880	58	1,473	20,000	9,072
RPP1802	0544-5048	Blue	1.00 - 1.50	25 - 38	0.88 - 1.12	22 - 29	80	2,032	61	1,549	30,700	13,955
RPP1803	0544-5051	Yellow	1.25 - 1.70	32 - 43	1.13 - 1.38	29 - 35	112	2,845	90	2,299	47,000	21,360
RPP1804	0544-5054	Aluminum	1.50 - 2.10	38 - 53	1.38 - 1.90	35 - 50	119	3,020	92	2,336	67,000	30,455
RPP6712	0544-5057	-	-	-	2.00 - 2.60	50.8 - 66.0	109.25	2775	100	2557	70,528	32,000
RPP7852	0544-5060	-	-	-	2.50 - 3.00	63.5 - 76.20	109.25	2775	100	2557	70,528	32,000

**MU Type - High Strength Cable Grip**

Part #	Stock Code	Color Code	Range		Lattice Length		Approx. Break Load	
			in	mm	in	mm	lb	kg
RPP1710	0544-5081	Dark Green	0.25 - 0.50	6 - 12	31	787	7,000	3,170
RPP1711	0544-5084	Brown	0.50 - 0.75	12 - 19	45	1,143	10,500	4,760
RPP1712	0544-5087	Light Blue	0.75 - 1.00	19 - 25	43	1,092	14,100	6,395
RPP1713	0544-5090	Gold	1.00 - 1.25	25 - 32	65	1,651	25,000	11,340
RPP1714	0544-5093	Black	1.25 - 1.50	32 - 38	59	1,499	31,000	14,065
RPP1715	0544-5096	Red	1.50 - 1.75	38 - 44	82	2,083	31,000	14,065
RPP1716	0544-5099	Dark Blue	1.75 - 2.25	44 - 57	82	2,083	49,000	22,230
RPP1750	0544-5102	Yellow	2.00 - 2.50	50 - 63	72	1,829	49,000	22,230
RPP1751	0544-5105	Orange	2.50 - 3.00	63 - 76	72	1,829	49,000	22,230
RPP1752	0544-5108	Aluminum	3.00 - 3.50	76 - 89	74	1,880	49,000	22,230
RPP1753	0544-5111	Light Green	3.50 - 4.00	89 - 102	76	1,930	49,000	22,230

Due to the tight construction of the A Type Cable Grip, use the RPP Feed Tube when inserting cable or rope into the grips. For ease of use, feed tubes are color-coded to match the A Type Cable Grip.

**Feed Tube**

This color-coded tube is used to insert cable or rope into grips. Recommended for A Type Cable Grip.



Part #	Stock Code	Tube to Fit Rope Diameter		Feed Tube Length		A Type Cable Grip Part #	Cable Grip Color
		in	mm	in	mm		
RPP1890	0544-5063	0.25 - 0.65	6 - 16	28	713	RPP1799, RPP3020	Black, Purple
RPP1891	0544-5066	0.50 - 0.90	13 - 23	40	1,018	RPP1800, RPP3522	Dark Green, Grey
RPP1892	0544-5069	0.75 - 1.10	19 - 28	52	1,324	RPP1801	Red
RPP1893	0544-5072	1.00 - 1.50	25 - 38	67	1,706	RPP1802	Blue
RPP1894	0544-5075	1.25 - 1.70	32 - 43	83	2,113	RPP1803	Yellow
RPP1895	0544-5078	1.50 - 2.10	38 - 53	96	2,444	RPP1804	Aluminum

**LINE PULLING SWIVEL**  
Bright Zinc Plated Steel

Swivels release torque from lines and prevent it from reaching dangerous levels, which can cause damage to the cable.

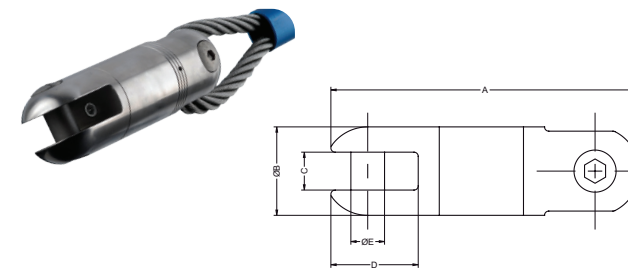

**Galvanized**

Essential for underground pulling and overhead applications, this swivel reduces the risk of line tangling during installation.

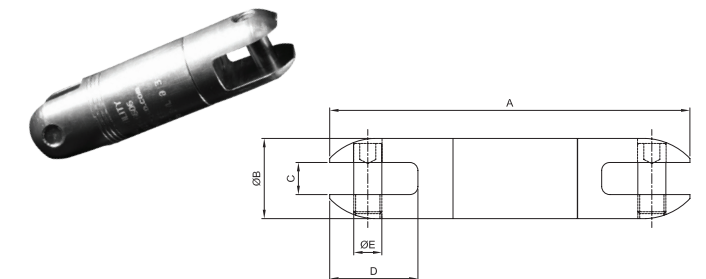

**Swivel and Cable Grip Match-Up**

Revolving Eye	Stock Code	MU Type Part #	Stock Code	A Type Part #	Stock Code	Min. Recommended Swivel	Stock Code
RPP2177	0544-5381	RPP1710	0544-5081	RPP1799	0544-5033	RPP2092	0544-5117
RPP2178	0544-5384	RPP1711	0544-5084	RPP3020	0544-5036	RPP2093	0544-5120
RPP2179	0544-0011	RPP1712	0544-5087	RPP1800	0544-5039	RPP2093	0544-5120
RPP2180	0544-5387	RPP1713	0544-5090	RPP3522	0544-5042	RPP2096	0544-5126
RPP2181	0544-5390	RPP1714	0544-5093	RPP1801	0544-5045	RPP2096	0544-5126
RPP2182	0544-5393	RPP1715	0544-5096	RPP1802	0544-5048	RPP2096	0544-5126
RPP2183	0544-5396	RPP1716	0544-5099	RPP1803	0544-5051	RPP2097	0544-5129

The above is intended as a rough guideline. The workload should be determined by the project requirements. A swivel with a higher working load than the recommended swivel may be used.

**Bright Zinc Plated Steel**

Part #	Stock Code	Safe Working Load		A	Ø B	C	D	Ø E
		Underground lb (kg)	Overhead lb (kg)	in (mm)	in (mm)	in (mm)	in (mm)	in (mm)
RPP2091	0544-5114	2,250 (1,015)	1,350 (610)	3.375 (86)	0.88 (22)	0.375 (10)	0.88 (22)	0.31 (8)
RPP2092	0544-5117	3,500 (1,590)	2,100 (955)	4 (99)	1 (25)	0.438 (11)	0.69 (26)	0.38 (10)
RPP2093	0544-5120	5,000 (2,240)	3,000 (1,345)	4.938 (126)	1.25 (32)	0.563 (14)	1.25 (32)	0.38 (10)
RPP2094	0544-5123	7,000 (3,170)	4,200 (1,900)	5.188 (132)	1.38 (35)	0.563 (14)	1.75 (36)	0.50 (12.5)
RPP2096	0544-5126	10,000 (4,530)	6,000 (2,700)	6.188 (157)	1.625 (41)	0.703 (18)	1.75 (45)	0.65 (16.5)
RPP2097	0544-5129	15,000 (6,730)	9,000 (4,030)	7.313 (186)	2.094 (53)	0.781 (20)	2.13 (54)	1.00 (18)

**Galvanized**

Part #	Stock Code	Safe Working Load		A	Ø B	C	D	Ø E
		Underground lb (kg)	Overhead lb (kg)	in (mm)	in (mm)	in (mm)	in (mm)	in (mm)
RPP2649	0544-5132	4,000 (1,815)	2,400 (1,085)	4 3/4 (121)	1 1/4 (32)	19/32 (15)	1 3/16 (30)	3/8 (10)
RPP2929	0544-5135	8,000 (3,630)	4,800 (2,175)	5 3/8 (136)	1 1/2 (38)	5/8 (16)	1 3/8 (35)	7/16 (11)
RPP6122	0544-5138	10,000 (4,530)	6,000 (2,700)	7 (178)	1 7/8 (48)	3/4 (19)	1 3/4 (44)	5/8 (16)
RPP6123	0544-7550	16,000 (7,142)	9,600 (4,355)	10 5/32 (258)	2 7/16 (62)	1(25)	2 11/16 (68)	7/8 (22)
RPP2857	0544-5144	30,000 (13,610)	18,000 (8,165)	11 1/8 (283)	2 1/2 (63)	1 (25)	2 3/4 (70)	7/8 (22)

3:1 factor of safety used, based on the ultimate load for underground use | 5:1 factor of safety used, based on the ultimate load for overhead use

**Swivel or Connector Model**

Swivel or Connector Model	RPP2091	RPP2092	RPP2093	RPP2094	RPP2096 RPP6122	RPP2097	RPP2929	RPP2649	RPP2857	RPP6123	RPP6554	RPP6555	RPP6556	RPP6557 RPP6558 RPP6559 RPP6560
---------------------------	---------	---------	---------	---------	--------------------	---------	---------	---------	---------	---------	---------	---------	---------	--

**Replacement Pin (HEX)**

Replacement Pin (HEX)	RPP2858	RPP2810	RPP2340	RPP2341	RPP2343	RPP2344	RPP2801	RPP2648	RPP2748	RPP5184	RPP2859	RPP2339	RPP5309	RPP5310
-----------------------	---------	---------	---------	---------	---------	---------	---------	---------	---------	---------	---------	---------	---------	---------

**SAFETY NOTE:** All RPP Line Pulling Swivels are designed for straight line pulling and will not support side loads as would be encountered traveling over a bull wheel. Swivel selection should be based on pulling line diameter, grip size, opening dimensions, pin sizes, working load, and sheave groove diameter. Swivels are not designed for general lifting.

**ST TYPE**  
Single Eye Double Weave • Cable Grip

For underground use. Ideal for pulling medium to heavy loads  
Used in underground installations, this grip has double weave construction for medium to heavy pulling applications.



**Short Length - Galvanized Steel**

Part #	Stock Code	Range		Lattice Length		Approx. Break Load	
		in	mm	in	mm	lb	kg
RPP2511	0544-5147	0.50 - 0.62	13 - 16	21	534	4,500	2,040
RPP2512	0544-5150	0.62 - 0.75	16 - 19	24	610	5,600	2,540
RPP2513	0544-5153	0.75 - 1.00	19 - 25	24	610	6,800	3,085
RPP2514	0544-5156	1.00 - 1.50	25 - 38	24	610	9,600	4,355
RPP2515	0544-5159	1.50 - 2.00	38 - 50	24	610	16,400	7,441
RPP2516	0544-5162	2.00 - 2.50	50 - 63	24	610	18,500	8,390
RPP2517	0544-5165	2.50 - 3.00	63 - 76	24	610	24,500	11,115
RPP2518	0544-5168	3.00 - 3.50	76 - 89	24	610	24,500	11,115
RPP2519	0544-5171	3.50 - 4.00	89 - 102	26	660	31,000	14,065

**Long Length - Galvanized Steel**

Part #	Stock Code	Range		Lattice Length		Approx. Break Load	
		in	mm	in	mm	lb	kg
RPP2520	0544-5174	0.75 - 1.00	19 - 25	36	914	6,800	3,085
RPP2521	0544-5177	1.00 - 1.50	25 - 38	36	914	9,600	4,355
RPP2522	0544-5180	1.50 - 2.00	38 - 50	36	914	16,400	7,440
RPP2523	0544-5183	2.00 - 2.50	50 - 63	36	914	18,500	8,390
RPP2524	0544-5186	2.50 - 3.00	63 - 76	36	914	24,500	11,115
RPP2777	0544-5189	3.00 - 3.50	76 - 89	36	914	24,500	11,115
RPP2778	0544-5192	3.50 - 4.00	89 - 102	40	1,010	31,000	14,065

**SE TYPE**  
Single Eye • Cable Grip

Ideal for pulling light to medium loads  
This standard grip is used for pulling single or a group of cables, making it ideal for light to medium loads. Can be used in conjunction with other grips.



**Single Eye Standard Grip - Galvanized Steel**

Part #	Stock Code	Range		Lattice Weave	Lattice Length		Overall Length		Approx. Break Load	
		in	mm		in	mm	in	mm	lb	kg
RPP0320	0532-2069	0.25 - 0.50	10 - 13	Single	9	230	12	305	1,680	760
RPP0321	0475-9134	0.50 - 0.75	13 - 19	Single	14	355	17	430	2,240	1,015
RPP0322	0475-9137	0.75 - 1.00	19 - 25	Single	16	405	20	510	5,600	2,540
RPP0323	0475-9140	1.00 - 1.50	25 - 38	Single	18	455	24	610	7,840	3,555
RPP0324	0475-9143	1.50 - 2.00	38 - 50	Double	21	535	29	735	11,200	5,080
RPP0325	0542-2707	2.00 - 2.50	50 - 63	Double	24	610	34	865	11,200	5,080
RPP0326	0475-9146	2.50 - 3.50	63 - 89	Double	27	685	39	990	13,440	6,095
RPP0327	0544-5195	3.50 - 4.50	89 - 115	Double	27	685	39	990	15,680	7,110
RPP0821	0544-5198	4.50 - 5.50	115 - 140	Double	27	685	39	990	15,680	7,110

**Single Eye Standard Grip - 316 Stainless Steel**

Part #	Stock Code	Range		Lattice Weave	Lattice Length		Overall Length		Approx. Break Load	
		in	mm		in	mm	in	mm	lb	kg
RPP1380	0544-5201	0.25 - 0.50	10 - 13	Single	9	230	12	305	1,344	610
RPP1523	0544-5204	0.50 - 0.75	13 - 19	Single	14	355	17	430	1,792	810
RPP1373	0544-5207	0.75 - 1.00	19 - 25	Single	16	405	20	510	4,480	2,030
RPP1952	0544-5210	1.00 - 1.50	25 - 38	Single	18	455	24	610	6,272	2,845
RPP1381	0544-5213	1.50 - 2.00	38 - 50	Double	21	535	29	735	8,960	4,065
RPP1977	0544-5216	2.00 - 2.50	50 - 63	Double	24	610	34	865	8,960	4,065
RPP1979	0544-5219	2.50 - 3.50	63 - 89	Double	27	685	39	990	10,752	4,875
RPP1980	0544-5222	3.50 - 4.50	89 - 115	Double	27	685	39	990	12,544	5,690
RPP1981	0544-5225	4.50 - 5.50	115 - 140	Double	27	685	39	990	12,544	5,690

Part #	Stock Code	Range		Lattice Length (M)		Eye Length (B)		Approx. Break Load	
		in	mm	in	mm	in	mm	lb	kg
RPP8562	0539-0085	0.25 - 0.36	6.4 - 9.1	7.5	190.5	2.5	63.5	450	204
RPP8563	0539-0082	0.37 - 0.49	9.4 - 12.4	11.0	279.4	3.0	76.2	900	408
RPP8564	0475-9149	0.50 - 0.61	12.7 - 15.5	12.5	317.5	3.0	76.2	1,300	589
RPP8565	0475-9152	0.62 - 0.74	15.7 - 19.0	16.5	419.1	4.5	114.3	1,950	884
RPP8566	0475-9155	0.75 - 0.99	19.1 - 25.1	17.0	431.8	4.0	101.6	2,800	1,270
RPP8567	0539-0088	1.00 - 1.25	25.4 - 31.5	17.5	444.5	4.5	114.3	3,900	1,769

**JUNIOR TYPE**  
Cable Grip

Ideal for pulling light loads



**FIBER OPTIC**  
Cable Grip

Ideal for pulling light to medium loads  
Made from galvanized steel, this grip is used for the installation of fiber optic cables for either overhead or underground applications.



Part #	Stock Code	Range		Lattice Length		Overall Length		Approx. Break Load	
		in	mm	in	mm	in	mm	lb	kg
RPP2008	0544-5228	0.11 - 0.23	2.5 - 5.6	11	265	18	455	950	431
RPP2009	0544-5231	0.21 - 0.36	5.3 - 9.2	15	370	22	560	1,650	748
RPP2010	0544-5234	0.32 - 0.49	8.1 - 12.5	19	470	27	690	2,200	998
RPP2011	0544-5237	0.42 - 0.62	10.7 - 5.8	20	515	29	735	2,750	1,247
RPP2012	0544-5240	0.53 - 0.75	13.5 - 19.1	23	595	32	815	3,700	1,678
RPP2013	0544-5243	0.64 - 0.88	16.3 - 22.4	25	645	34	865	4,250	1,928
RPP2014	0544-5246	0.75 - 1.00	19.1 - 25.5	27	720	37	940	4,250	1,928

**CABLE CONTROL & GUIDANCE**

**Anti-Rotational Device**

This device prevents the cable from twisting as it travels over pulling blocks, avoiding irreparable damage to it. Best used with Fiber Optic Cable Grip and OPGW cable.

**Specification**

Part #	Stock Code	Overall Length	Working Load *	Length of Attachment	Weight of Attachment
RPP3799	0544-5249	29' Approx.	5,000 lb	8' Approx.	14 lb each approx.

\* 3:1 Safety Factor

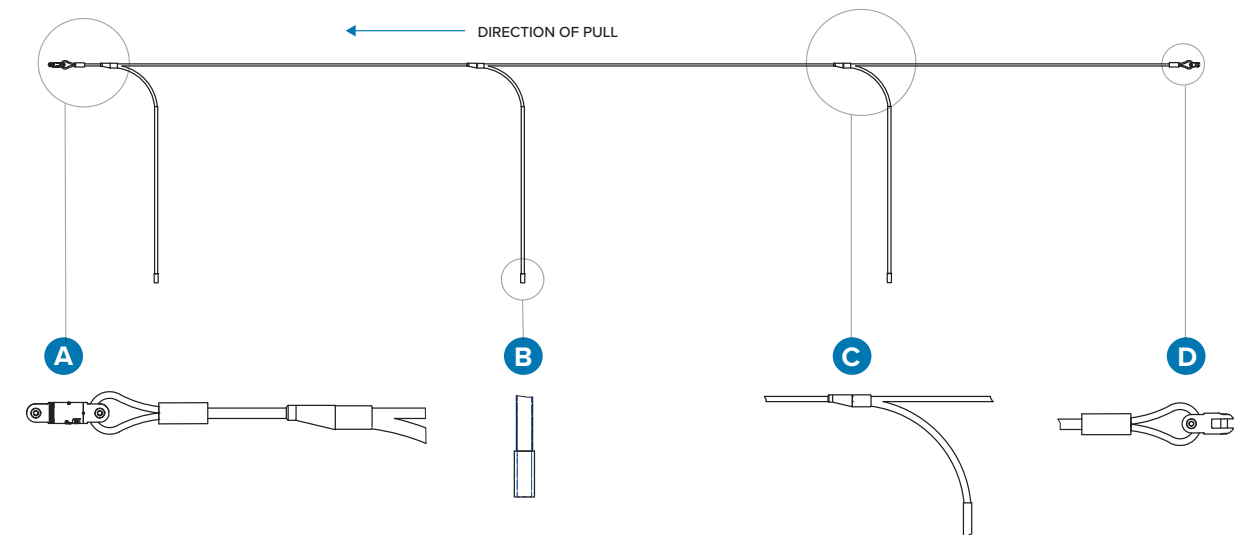
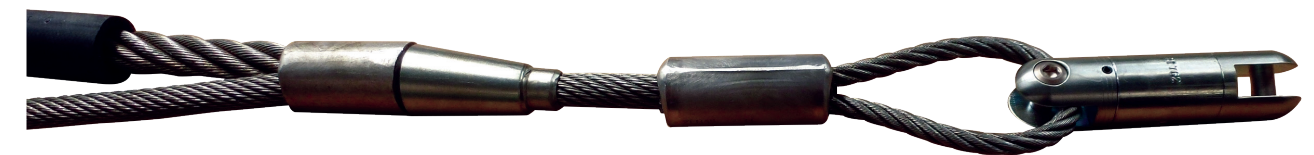

**OS TYPE**  
Offset Eye • Cable Grip

**Ideal for light to medium loads**  
Used for when offset positioning is required, this grip pulls slack out of lines that have been pulled. Similar to the SE Type Cable Grip.



Part #	Stock Code	Range		Lattice Weave	Lattice Length		Overall Length		Approx. Break Load	
		in	mm		in	mm	in	mm	lb	kg
<b>OFFSET EYE STANDARD GRIP - GALVANIZED STEEL</b>										
RPP1860	0544-5252	0.25 - 0.50	6 - 13	Single	9	230	12	305	1,680	760
RPP1861	0544-5255	0.50 - 0.75	13 - 19	Single	14	355	17	430	2,240	1,015
RPP1862	0544-5258	0.75 - 1.00	19 - 25	Single	16	405	20	510	5,600	2,540
RPP1863	0544-5261	1.00 - 1.50	25 - 38	Single	18	455	24	610	7,840	3,555
RPP1864	0544-5264	1.50 - 2.00	38 - 50	Double	21	535	29	735	11,200	5,080
RPP1865	0544-5267	2.00 - 2.50	50 - 63	Double	24	610	34	865	11,200	865
RPP1866	0544-5270	2.50 - 3.50	63 - 89	Double	27	685	39	990	13,440	6,095
RPP1867	0544-5273	3.50 - 4.50	89 - 115	Double	27	685	39	685	15,680	7,110
RPP1974	0544-5276	4.50 - 5.50	115 - 140	Double	27	685	39	990	15,680	7,110
<b>OFFSET EYE STANDARD GRIP - 316 STAINLESS STEEL</b>										
RPP1986	0544-5279	0.25 - 0.50	6 - 13	Single	9	230	12	305	1,344	610
RPP1987	0544-5282	0.50 - 0.75	13 - 19	Single	14	355	17	430	1,792	810
RPP1988	0544-5285	0.75 - 1.00	19 - 25	Single	16	405	20	510	4,480	2,030
RPP1989	0544-5288	1.00 - 1.50	25 - 38	Single	18	455	24	610	6,272	2,845
RPP1990	0544-5291	1.50 - 2.00	38 - 50	Double	21	535	29	735	8,960	4,065
RPP1991	0544-5294	2.00 - 2.50	50 - 63	Double	24	610	34	865	8,960	4,065
RPP1992	0544-5297	2.50 - 3.50	63 - 89	Double	27	685	39	990	10,752	4,875
RPP1993	0544-5300	3.50 - 4.50	89 - 115	Double	27	685	39	990	12,544	5,690
RPP1994	0544-5303	4.50 - 5.50	115 - 140	Double	27	685	39	990	12,544	5,690
RPP3994	0544-5306	5.50 - 7.00	140 - 180	Double	24	610	39	990	4,500	2,009
RPP4069	0544-5309	8.0 - 9.0	203 - 229	Double	59	1,500	74	1,880	20,000	8,928

**L TYPE**  
Lace Up • Cable Grip

**Ideal for light to medium loads**  
Used in pulling when the end of the cable is not accessible, this grip is fitted to the cable being pulled by stitching it together. See Lace Up instructions on page 33.



Part #	Stock Code	Range		Lattice Weave	Lattice Length		Overall Length		Approx. Break Load	
		in	mm		in	mm	in	mm	lb	kg
<b>LACE UP STANDARD GRIP - GALVANIZED STEEL</b>										
RPP1157	0544-5312	0.25 - 0.50	10 - 13	Single	9	230	12	305	1,680	760
RPP0872	0544-5315	0.50 - 0.75	13 - 19	Single	14	355	17	430	2,240	1,015
RPP0871	0544-5318	0.75 - 1.00	19 - 25	Single	16	405	20	510	5,600	2,540
RPP0328	0544-5321	1.00 - 1.50	25 - 38	Single	18	455	24	610	7,840	3,555
RPP0329	0544-5324	1.50 - 2.00	38 - 50	Double	21	535	29	735	11,200	5,080
RPP0330	0544-5327	2.00 - 2.50	50 - 63	Double	24	610	34	865	11,200	5,080
RPP0331	0544-5330	2.50 - 3.50	63 - 89	Double	27	685	39	990	13,440	6,095
RPP0853	0544-5333	3.50 - 4.50	89 - 115	Double	27	685	39	990	15,680	7,110
RPP1109	0544-5336	4.50 - 5.50	115 - 140	Double	27	685	39	990	15,680	7,110
RPP4463	0544-5339	4.72 - 5.90	120 - 150	Triple	59	1,500	102	2,600	32,928	14,700
RPP3270	0544-5342	7.90 - 8.70	200 - 220	Triple	78	2,000	102	2,600	71,680	32,000
<b>LACE UP STANDARD GRIP - 316 STAINLESS STEEL</b>										
RPP1983	0544-5345	0.25 - 0.50	10 - 13	Single	9	230	12	305	1,344	610
RPP1796	0544-5348	0.50 - 0.75	13 - 19	Single	14	355	17	430	1,792	810
RPP1789	0544-5351	0.75 - 1.00	19 - 25	Single	16	405	20	510	4,480	2,030
RPP1797	0544-5354	1.00 - 1.50	25 - 38	Single	18	455	24	610	6,272	2,845
RPP1984	0544-5357	1.50 - 2.00	38 - 50	Double	21	535	29	735	8,960	4,065
RPP2466	0544-5360	2.00 - 2.50	50 - 63	Double	24	610	34	865	8,960	4,065
RPP0816	0544-5363	2.50 - 3.50	63 - 89	Double	27	685	39	990	10,752	4,875
RPP5094	0544-5366	2.75 - 3.44	69 - 87	Multi	55	1,390	81	2,063	40,000	17,857
RPP1356	0544-5369	3.50 - 4.50	89 - 115	Double	27	685	39	990	12,544	5,690
RPP2832	0544-5372	3.50 - 4.50	89 - 115	Triple	27	685	39	990	14,012	6,300
RPP1355	0544-5375	4.50 - 5.50	115 - 140	Double	27	685	39	990	12,544	5,690
RPP2833	0544-5378	4.50 - 5.50	115 - 140	Triple	27	685	39	990	16,128	7,315

**R TYPE**  
Rotating Eye  
Multi-Weave • Cable Grip

**Ideal for heavy loads**  
The steel-forged revolving head of this color-coded grip is ideal for connecting to swivels. Has triple weave construction.



Part #	Stock Code	Color Code		Range		Lattice Length		Approx. Break Load	
				in	mm	in	mm	lb	kg
RPP2177	0544-5381	Dark Green	●	0.25 - 0.50	6 - 12	31	787	7,000	3,170
RPP2178	0544-5384	Brown	●	0.50 - 0.75	12 - 19	45	1,143	10,500	4,760
RPP2179	0544-0011	Light Blue	●	0.75 - 1.00	19 - 25	43	1,092	14,100	6,395
RPP2180	0544-5387	Gold	●	1.00 - 1.25	25 - 32	65	1,651	25,000	11,340
RPP2181	0544-5390	Black	●	1.25 - 1.50	32 - 38	59	1,499	31,000	14,065
RPP2182	0544-5393	Red	●	1.50 - 1.75	38 - 44	82	2,083	31,000	14,065
RPP2183	0544-5396	Dark Blue	●	1.75 - 2.25	44 - 57	82	2,083	43,000	19,510
RPP2779	0544-5399	Yellow	●	2.00 - 2.50	50 - 63	72	1,829	43,000	19,510
RPP2780	0544-5402	Orange	●	2.50 - 3.00	63 - 76	72	1,829	43,000	19,510
RPP2781	0544-5405	Aluminum	●	3.00 - 3.50	76 - 89	74	1,880	43,000	19,510
RPP2782	0544-5408	Light Green	●	3.50 - 4.00	89 - 102	76	1,930	43,000	19,510

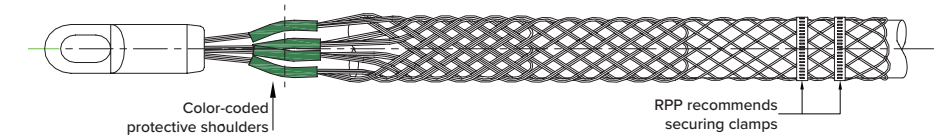

**RT TYPE**  
Rotating Eye Double  
Weave • Cable Grip

**Ideal for heavy loads**  
The steel-forged revolving head of this color-coded grip is ideal for connecting to swivels. Has double weave construction.



Part #	Stock Code	Range		Lattice Length		Approx. Break Load	
		in	mm	in	mm	lb	kg
<b>SHORT LENGTH - GALVANIZED STEEL</b>							
RPP2734	0544-5411	0.50 - 0.62	13 - 16	11	280	5,600	2,540
RPP2735	0544-5414	0.62 - 0.75	16 - 19	11	280	6,800	3,085
RPP2736	0544-5417	0.75 - 1.00	19 - 25	20	508	6,800	3,085
RPP2738	0544-5420	1.00 - 1.50	25 - 38	21	533	12,800	5,805
RPP2739	0544-5423	1.50 - 2.00	38 - 50	25	635	16,400	7,440
RPP2740	0544-5426	2.00 - 2.50	50 - 63	26	660	27,200	12,340
RPP2741	0544-5429	2.50 - 3.00	63 - 76	28	711	33,000	14,970
RPP2742	0544-5432	3.00 - 3.50	76 - 89	30	762	41,000	18,600
RPP2743	0544-5435	3.50 - 4.00	89 - 102	32	813	43,000	19,510
RPP2744	0544-5438	4.00 - 4.50	102 - 115	33	838	43,000	19,510
<b>STANDARD - LONG LENGTH - GALVANIZED STEEL</b>							
RPP2745	0544-5441	0.50 - 0.62	13 - 16	16	406	5,600	2,540
RPP2746	0544-5444	0.62 - 0.75	16 - 19	16	406	6,800	3,085
RPP2747	0544-5447	0.75 - 1.00	19 - 25	32	812	9,600	4,355
RPP2748	0544-5450	1.25 - 1.50	25 - 38	33	838	16,400	5,805
RPP2749	0544-5453	1.50 - 2.00	38 - 50	34	863	16,400	7,440
RPP2750	0544-5456	2.00 - 2.50	50 - 63	36	914	27,300	12,340
RPP2751	0544-5459	2.50 - 3.00	63 - 76	38	965	33,000	14,970
RPP2752	0544-5462	3.00 - 3.50	76 - 89	39	990	41,000	18,600
RPP2753	0544-5465	3.50 - 4.00	89 - 102	41	1,041	43,000	19,510
RPP2754	0544-5468	4.00 - 4.50	102 - 115	42	1,066	43,000	19,510
RPP2755	0544-5471	4.50 - 5.00	115 - 127	58	1,473	43,000	19,510
RPP2756	0544-5474	5.00 - 6.00	127 - 153	60	1,524	43,000	19,510
RPP2757	0544-5477	6.00 - 7.00	153 - 178	66	1,676	43,000	19,510

**Warning:** R Type Cable Grip and RT Type Cable Grip do not revolve under load and do not replace the use of a line swivel. Please see page 5 for swivel and grip match-up, and safety and technical information.

**OPEN-ENDED Cable Grip**

**Ideal for light to medium loads**  
This grip is ideal for joining two cables to form a continuous loop. Also used to temporarily splice cable and conductor where torsion forces are NOT an issue. Where torsion is present a swivel and two grips should be used.



Part #	Stock Code	Range	Lattice Weave	Lattice Length	Approx. Break Load	
		in		in	lb	kg
<b>OPEN-ENDED STANDARD GRIP - GALVANIZED STEEL</b>						
RPP0313	0544-5480	0.25 - 0.50	Single	15	1,680	760
RPP6420	0544-5483	0.25 - 0.50	Double	22	3,500	1,588
RPP0314	0544-5486	0.50 - 0.75	Single	24	2,240	1,015
RPP6421	0544-5489	0.50 - 0.75	Double	30	4,500	2,040
RPP6425	0544-5492	0.50 - 0.75	Multi	70	7,500	3,400
RPP0315	0544-5495	0.75 - 1.00	Single	28	5,600	2,540
RPP6422	0544-5498	0.75 - 1.00	Double	30	8,000	3,630
RPP6426	0544-5501	0.75 - 1.00	Multi	80	11,800	5,352
RPP0316	0544-5504	1.00 - 1.50	Single	32	7,840	3,555
RPP6423	0544-5507	1.00 - 1.50	Double	36	10,000	4,537
RPP6427	0544-5510	1.00 - 1.50	Multi	90	20,000	9,070
RPP0317	0544-5513	1.50 - 2.00	Double	36	11,200	5,080
RPP0318	0544-5516	2.00 - 2.50	Double	42	11,200	5,080
RPP1158	0544-5519	2.50 - 3.50	Double	48	13,440	6,095
RPP1159	0544-5522	3.50 - 4.50	Double	54	15,680	7,110
RPP6424	0544-5525	4.25 - 4.88	Triple	55	19,500	8,847
RPP1975	0544-5528	4.50 - 5.50	Double	54	15,680	7,110
<b>OPEN-ENDED STANDARD GRIP - 316 STAINLESS STEEL</b>						
RPP1995	0544-5531	0.25 - 0.50	Single	15	1,344	610
RPP1996	0544-5534	0.50 - 0.75	Single	24	1,792	810
RPP1997	0544-5537	0.75 - 1.00	Single	28	4,480	2,030
RPP1998	0544-5540	1.00 - 1.50	Single	32	6,272	2,845
RPP1999	0544-5543	1.50 - 2.00	Double	36	8,960	4,065
RPP2000	0544-5546	2.00 - 2.50	Double	42	8,960	4,065
RPP2001	0544-5549	2.50 - 3.50	Double	48	10,752	4,875
RPP2002	0544-5552	3.50 - 4.50	Double	54	12,544	5,690
RPP2003	0544-5555	4.50 - 5.50	Double	54	12,544	5,690

**CONNECTORS: 90°, Rope to Rope, Rope to Swivel**

Safely connect rope, swivels, and other objects with these connectors. Comes with high-strength pins and smooth rollers to connect rope without fraying or damage.

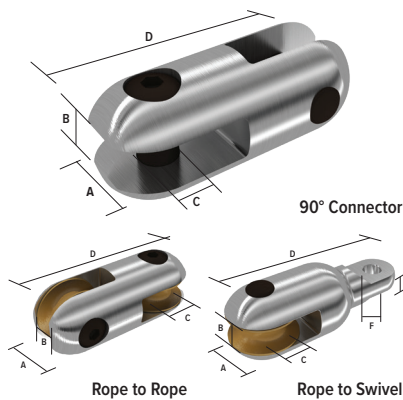

**90° Connector**

Part #	Stock Code	Safe Working Load	A	B	C	D	Weight
		lb (kg)	in (mm)	in (mm)	in (mm)	in (mm)	lb (kg)
RPP6554	0544-5558	2,500 (1,134)	7/8 (22)	3/8 (9.6)	5/16 (8)	2 1/8 (54.0)	0.17 (0.08)
RPP6555	0544-5561	5,000 (2,240)	1 1/4 (31.8)	17/32 (13.5)	13/32 (10)	2 7/8 (73.0)	0.46 (0.21)
RPP6556	0544-5564	9,000 (4,030)	1 1/2 (38.1)	19/32 (15)	1/2 (12.5)	3 3/8 (86)	0.73 (0.33)
RPP6557	0544-5567	15,000 (6,800)	2 (50.8)	25/32 (20)	11/16 (18.0)	4 9/16 (116)	2.00 (0.91)

**Rope to Rope Connector**

Part #	Stock Code	Safe Working Load	Max Rope Dia.	A	B	C	D	Weight
		lb (kg)	in (mm)	in (mm)	in (mm)	in (mm)	in (mm)	lb (kg)
RPP6558	0544-5570	15,000 (6,800)	7/8 (22.2)	2 (50.8)	15/16 (24)	11/16 (18)	5 1/2 (140)	2.70 (1.23)

**Rope to Swivel Connector**

Part #	Stock Code	Safe Work. Load	Max Rope Dia.	A	B	C	D	E	F	Weight
		lb (kg)	in (mm)	in (mm)	in (mm)	in (mm)	in (mm)	in (mm)	in (mm)	lb (kg)
RPP6559	0544-5573	7,000 (3,170)	7/8 (22.2)	2 (50.8)	15/16 (24)	11/16 (18)	5 5/16 (135)	1/2 (12.7)	17/32 (13.5)	2.70 (1.23)
RPP6560	0544-5576	15,000 (6,800)	7/8 (22.2)	2 (50.8)	15/16 (24)	11/16 (18)	5 3/8 (137)	21/32 (16.7)	3/4 (18)	2.00 (0.91)

Safe working load based upon 3:1 factor of safety.

**SPLICING GRIP**

**Rotating Swivel Link**

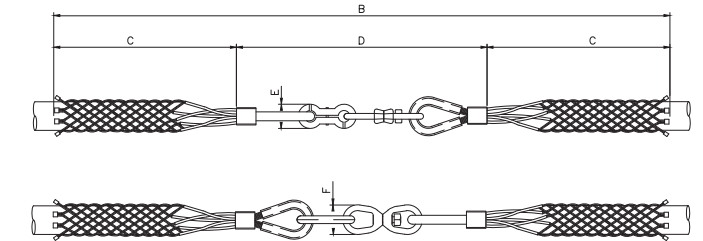

Available with different sizes for each side, this grip is perfect for stringing replacement wire and cable on equipment, and in drilling or rigging systems. Link opens for easy installation and adjustment.

Part #	Stock Code	Range	B Length		C Length		D Length		E Length		F Length		Approx. Break Load		
		in	mm	in	mm	in	mm	in	mm	in	mm	in	mm	lb	kg
RPP3493	0544-5579	0.25 - 0.50	6 - 13	100.0	2,540	44.3	1,127	11.3	288	0.87	22	1.25	32	2,400	1,089
RPP3494	0544-5582	0.50 - 1.00	13 - 25	103.8	2,641	46.0	1,170	11.8	301	1.38	35	1.25	32	3,526	1,599
RPP3495	0544-5585	1.00 - 1.50	25 - 38	103.0	2,614	44.9	1,140	13.1	334	1.61	41	1.61	41	5,070	2,300
RPP3496	0544-5588	1.50 - 2.00	38 - 51	101.0	2,573	43.7	1,110	13.9	353	1.61	41	2.0	51	8,000	3,629
RPP3497	0544-5591	2.00 - 2.75	51 - 70	100.0	2,540	42.9	1,090	13.9	353	1.61	41	2.0	51	10,000	4,530
RPP3498	0544-5594	2.75 - 3.50	70 - 90	118.0	3,013	52.3	1,330	13.9	353	1.61	41	2.0	51	10,000	4,530
RPP3499	0544-5597	3.50 - 4.25	89 - 108	117.0	2,973	51.6	1,310	13.9	353	1.61	41	2.0	51	10,000	4,530

**Rotating Barrel**

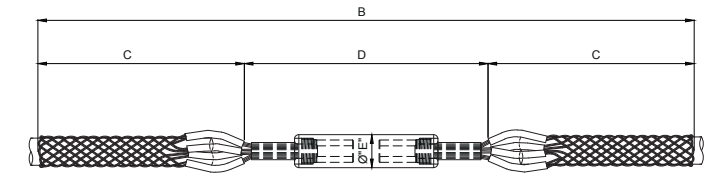
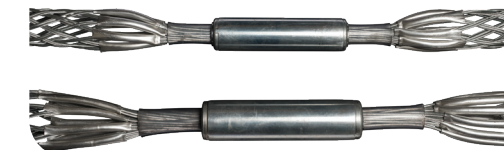

This grip has a high-capacity swivel that travels smoothly when being strung in straight line pulling.

Part #	Stock Code	Range	B Length		C Length		D Length		Approx. Break Load		
		in	mm	in	mm	in	mm	in	mm	lb	kg
RPP3505	0544-5600	0.25 - 0.50	6 - 13	66.1	1,680	29.7	755	6.7	170	4,400	1,964
RPP3506	0544-5603	0.50 - 1.00	13 - 25	87.8	2,230	40.0	1,015	7.9	200	7,400	3,304
RPP3507	0544-5606	1.00 - 1.50	25 - 38	79.9	2,030	35.2	895	9.5	240	10,000	4,530
RPP3508	0544-5609	1.50 - 2.00	38 - 51	72.0	1,830	31.3	795	9.5	240	12,000	5,357
RPP3509	0544-5612	2.00 - 2.75	51 - 70	85.8	2,180	37.0	940	11.8	300	16,000	7,142
RPP3510	0544-5615	2.75 - 3.50	70 - 90	107.5	2,730	47.0	1,195	13.3	340	20,000	8,928
RPP3511	0544-5618	3.50 - 4.25	89 - 108	104.3	2,650	44.5	1,130	15.3	390	24,000	10,714

**CONNECTOR**

**Figure 8 'Swing Link'**

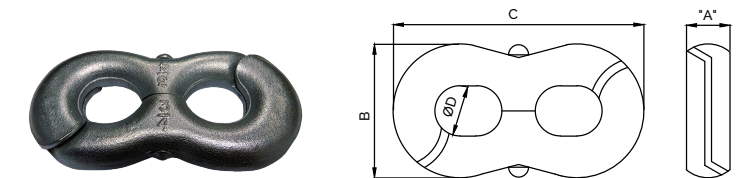

Part #	Stock Code	A	B	C	Ø D		Approx. Break Load		
		in	mm	in	mm	in	mm	lb	kg
RPP-SWI4281	0544-5621	0.50	13	1.62	41	3.25	83	10000	4537
RPP-SWI4282	0544-5624	0.75	19	2.43	62	5.00	127	18000	8167

**DE TYPE**  
**Double Eye • Cable Grip**

**Ideal for pulling light to medium loads**  
This grip is excellent as a hose restraint for low PSI-rated hoses.

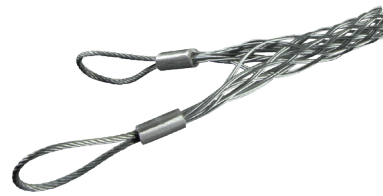

Part #	Stock Code	Range		Lattice Weave	Lattice Length		Overall Length		Approx. Break Load	
		in	mm		in	mm	in	mm	lb	kg
<b>DOUBLE EYE STANDARD GRIP - GALVANIZED STEEL</b>										
RPP0305	0544-5627	0.25 - 0.50	10 - 13	Single	9	230	12	305	1,680	760
RPP0306	0544-5630	0.50 - 0.75	13 - 19	Single	14	355	17	430	2,240	1,015
RPP0307	0544-5633	0.75 - 1.00	19 - 25	Single	16	405	20	510	5,600	2,540
RPP0308	0544-5636	1.00 - 1.50	25 - 38	Single	18	455	24	610	7,840	3,555
RPP0309	0544-5639	1.50 - 2.00	38 - 50	Double	21	535	29	735	11,200	5,080
RPP0310	0544-5642	2.00 - 2.50	50 - 63	Double	24	610	34	865	11,200	5,080
RPP0311	0544-5645	2.50 - 3.50	63 - 89	Double	27	685	39	990	13,440	6,095
RPP0312	0544-5648	3.50 - 4.50	89 - 115	Double	27	685	39	990	15,680	7,110
RPP0878	0544-5651	4.50 - 5.50	115 - 140	Double	27	685	39	990	15,680	7,110
<b>DOUBLE EYE STANDARD GRIP - 316 STAINLESS STEEL</b>										
RPP0823	0544-5654	0.25 - 0.50	10 - 13	Single	9	230	12	305	1,344	610
RPP1007	0544-5657	0.50 - 0.75	13 - 19	Single	14	355	17	430	1,792	810
RPP0931	0544-5660	0.75 - 1.00	19 - 25	Single	16	405	20	510	4,480	2,030
RPP1265	0544-5663	1.00 - 1.50	25 - 38	Single	18	455	24	610	6,272	2,845
RPP3995	0544-5666	1.14 - 1.57	29 - 40	Double	50	1,270	62	1,575	35,000	15,625
RPP1252	0544-5669	1.50 - 2.00	38 - 50	Double	21	535	29	735	8,960	4,065
RPP0319	0544-5672	2.00 - 2.50	50 - 63	Double	24	610	34	865	8,960	4,065
RPP0213	0544-5675	2.50 - 3.50	63 - 89	Double	27	685	39	990	10,752	4,875
RPP4873	0544-5678	2.50 - 3.50	63 - 89	Double	70	1,778	80	2,032	13,500	6,027
RPP4596	0544-5681	2.50 - 3.50	63 - 89	Triple	56	1,422	152	3,860	16,138	7,204
RPP0332	0544-5684	3.50 - 4.50	89 - 115	Double	27	685	39	990	12,544	5,690
RPP1982	0544-5687	4.50 - 5.50	115 - 140	Double	27	685	39	990	12,544	5,690
RPP4869	0544-5690	4.50 - 5.50	115 - 140	Double	70	1,778	80	2,032	13,500	6,027

**HOSE RESTRAINT**  
**Cable Grip**

**Ideal for pulling heavy loads**  
This restraint grip is designed to prevent whipping in the event of a pressurized hose becoming detached from its fitting.



Part #	Stock Code		Range		Lattice Length		Lattice Weave	Approx. Break Load	
			in	mm	in	mm		lb	kg
<b>DOUBLE THIMBLE EYE - GALVANIZED STEEL</b>									
RPP5363	0544-5693	Thimble eye	1.0 - 1.5	25 - 38	26	660	Double	11,000	4,911
RPP5364	0544-5696	Thimble eye	1.5 - 2.5	38 - 63	40	1,016	Double	20,000	8,928
RPP5365	0544-5699	Thimble eye	2.5 - 3.5	63 - 89	42	1,067	Double	22,000	9,821
RPP5366	0544-5702	Thimble eye	3.5 - 4.5	89 - 114	44	1,118	Double	27,000	12,053
RPP5367	0544-5705	Thimble eye	4.5 - 5.5	114 - 140	48	1,219	Double	31,000	13,839
RPP6012	0544-5708	Thimble eye	5.5 - 7.0	140 - 180	60	1,524	Double	50,000	22,685
RPP5529	0544-5711	Thimble eye	7.0 - 9.25	180 - 240	78	2,000	Triple	66,000	30,000
<b>DOUBLE THIMBLE EYE - 316 STAINLESS STEEL</b>									
RPP5650	0544-5714	Thimble eye	1.0 - 1.5	25 - 38	26	660	Double	7,700	3,437
RPP5651	0544-5717	Thimble eye	1.5 - 2.5	38 - 63	40	1,016	Double	14,000	6,250
RPP5652	0544-5720	Thimble eye	2.5 - 3.5	63 - 89	42	1,067	Double	15,400	6,874
RPP5653	0544-5723	Thimble eye	3.5 - 4.5	89 - 114	44	1,118	Double	18,900	8,437
RPP5654	0544-5726	Thimble eye	4.5 - 5.5	114 - 140	48	1,219	Double	21,700	9,687
RPP6000	0544-5729	Thimble eye	5.5 - 7.0	140 - 180	60	1,524	Double	35,000	15,880
<b>DOUBLE EYE MULTI-WEAVE - MAX STRENGTH - 316 STAINLESS STEEL</b>									
RPP3995	0544-5666	Thimble eye	1.14 - 1.57	29 - 40	50	1,270	Double	35,000	15,625
RPP3295	0544-5732	Flex eye	2.75 - 3.44	70 - 87	58	1,460	Multi	49,000	22,230
RPP3254	0544-5735	Flex eye	3.00 - 3.50	76 - 89	58	1,460	Multi	39,200	17,785
RPP6004	0544-5738	Flex eye	3.50 - 4.75	89 - 120	58	1,460	Multi	50,000	22,320
RPP3414	0544-5741	Flex eye	4.75 - 5.10	120 - 130	78	1,981	Multi	106,000	48,095

**MARINE**  
**Cable Grip**

**Ideal for pulling extremely heavy loads**  
This specialty grip is extremely heavy duty and suitable for large underwater pulls, underwater cable installation, and other applications in the oil and gas industries. Available in single eye, double eye, and double eye lace up.



Part #	Stock Code	Range		Lattice Length		Approx. Break Load	
		in	mm	in	mm	lb	kg
<b>SINGLE EYE</b>							
RPP3525	0544-5744	4 - 5	102 - 127	94	2,360	100,000	45,370
RPP3526	0544-5747	5 - 6	127 - 152	94	2,360	105,000	47,640
RPP3527	0544-5750	6 - 8	152 - 203	94	2,360	112,000	50,815
RPP3528	0544-5753	8 - 10	203 - 255	94	2,360	138,000	62,600
RPP3529	0544-5756	10 - 12	255 - 305	94	2,360	138,000	62,600
RPP3530	0544-5759	12 - 14	305 - 355	94	2,360	138,000+	62,600+
RPP3531	0544-5762	14 - 16	355 - 406	118.11	2,950	138,000+	62,600+
RPP3532	0544-5765	16 - 18	406 - 457	131.79	3,290	138,000+	62,600+
RPP3533	0544-5768	18 - 20	457 - 508	157.48	3,940	138,000+	62,600+
RPP3534	0544-5771	20 - 23	508 - 584	196.85	4,920	138,000+	62,600+
<b>DOUBLE EYE</b>							
RPP3535	0544-5774	4 - 5	102 - 127	94	2,360	123,000	55,800
RPP3536	0544-5777	5 - 6	127 - 152	94	2,360	123,000	55,800
RPP3537	0544-5780	6 - 8	152 - 203	94	2,360	127,500	57,850
RPP3538	0544-5783	8 - 10	203 - 255	94	2,360	156,500	71,000
RPP3539	0544-5786	10 - 12	255 - 305	94	2,360	156,500	71,000
RPP3540	0544-5789	12 - 14	305 - 355	94	2,360	156,500+	71,000
RPP3541	0544-5792	14 - 16	355 - 406	118.11	2,950	156,000+	71,000+
RPP3542	0544-5795	16 - 18	406 - 457	131.79	3,290	156,500+	71,000+
RPP3543	0544-5798	18 - 20	457 - 508	157.48	3,940	156,500+	71,000+
RPP3544	0544-5801	20 - 23	508 - 584	196.85	4,920	156,500+	71,000+
<b>DOUBLE EYE LACE UP</b>							
RPP3545	0544-5804	4 - 5	102 - 127	94	2,360	123,000	55,800
RPP3546	0544-5807	5 - 6	127 - 152	94	2,360	123,000	55,800
RPP3547	0544-5810	6 - 8	152 - 203	94	2,360	127,500	57,850
RPP3548	0544-5813	8 - 10	203 - 255	94	2,360	156,500	71,000
RPP3549	0544-5816	10 - 12	255 - 305	94	2,360	156,500	71,000
RPP3550	0544-5819	12 - 14	305 - 355	94	2,360	156,500+	71,000
RPP3551	0544-5822	14 - 16	355 - 406	118.11	2,950	156,000+	71,000+
RPP3552	0544-5825	16 - 18	406 - 457	131.79	3,290	156,500+	71,000+
RPP3553	0544-5828	18 - 20	457 - 508	157.48	3,940	156,500+	71,000+
RPP3554	0544-5831	20 - 23	508 - 584	196.85	4,920	156,500+	71,000+

## Non-Metallic (Aramid) Cable Grips

For Pulling Cable In Many Industrial & Commercial Projects

### Features:

- Break loads similar to steel cable grips
- Lightweight
- No more frayed grip wires
- UV Resistant
- Strong enough to last in salt water, pollutants, and underground

Non-Metallic (Aramid) Cable Grips are ideal for use in fiber optic cable installation operations, offshore applications, or for a multitude of uses in the utilities industry. Now with an improved weight to break ratio, these grips are made of a high-strength, non-metallic aramid fiber with UV protective coating. They are suitable for pulling single cable and multiple cable bundles.



Thanks to the non-metallic material, these grips are easy to work even without gloves and offer an alternative to steel grips. We have many different styles of Non-Metallic (Aramid) Cable Grips for your project, such as Single Eye, Double Eye, Offset Eye, Lace Up, Mining, and the new Single Eye Double Weave Grips made of ultra-flex Aramid material.

### NS TYPE Non-Metallic (Aramid) Single Eye • Cable Grip



Single Weave • Non-Metallic

Part #	Stock Code	Range		Lattice Length		Approx. Break Load	
		in	mm	in	mm	lb	kg
<b>SINGLE EYE SINGLE WEAVE NON-METALLIC CABLE GRIP</b>							
RPP1040	0544-5834	0.38 - 0.75	10 - 20	24	600	2,460	1,115
RPP1022	0544-5837	0.75 - 1.25	20 - 30	24	600	3,580	1,620
RPP2923	0544-5840	1.00 - 1.50	25 - 36	24	600	3,580	1,620
RPP1041	0544-5843	1.25 - 1.50	30 - 40	24	600	4,920	2,230
RPP1042	0544-5846	1.50 - 2.00	40 - 50	24	600	5,820	2,640
<b>SINGLE EYE DOUBLE WEAVE NON-METALLIC CABLE GRIP</b>							
RPP1023	0544-5849	1.25 - 1.50	30 - 40	24	600	9,860	4,470
RPP1024	0544-5852	1.50 - 2.00	40 - 50	24	600	11,880	5,390
RPP1179	0544-5855	2.00 - 2.50	50 - 65	24	600	15,900	7,210
RPP1180	0544-5858	2.50 - 3.00	65 - 76	24	600	15,900	7,210
RPP1181	0544-5861	3.00 - 4.00	76 - 100	24	600	15,900	7,210
RPP4079	0544-5864	4.00 - 5.00	102 - 127	120	3,048	15,900	7,210

Part #	Stock Code	Range		Color Code	Approx. Break Load		
		in	mm		lb	kg	
<b>ULTRA-FLEX SINGLE EYE DOUBLE WEAVE NON-METALLIC CABLE GRIP</b>							
RPP09336	0544-5867	0.63 - 0.75	16 - 19	Yellow	●	5,000	2,267
RPP09337	0544-5870	0.75 - 1.00	19 - 25	Red	●	6,000	2,721
RPP09338	0544-5873	1.00 - 1.25	25 - 31	Blue	●	6,000	2,721
RPP09339	0544-5876	1.25 - 1.50	31 - 38	White	○	6,000	2,721

Double Weave • Non-Metallic

### ND TYPE Non-Metallic (Aramid) Double Eye • Cable Grip



### NO TYPE Non-Metallic (Aramid) Offset Eye • Cable Grip



Single Offset Eye Single Weave Non-Metallic Cable Grip



Single Offset Eye Lace Up Non-Metallic Cable Grip



Double Offset Eye Non-Metallic Cable Grip

Part #	Stock Code	Range		Lattice Length		Approx. Break Load	
		in	mm	in	mm	lb	kg
<b>DOUBLE EYE SINGLE WEAVE NON-METALLIC CABLE GRIP</b>							
RPP1148	0544-5879	0.38 - 0.75	10 - 20	24	600	2,460	1,115
RPP1176	0544-5882	0.75 - 1.25	20 - 30	24	600	3,580	1,620
RPP2922	0544-5885	1.00 - 1.50	25 - 36	24	600	3,580	1,620
RPP1177	0544-5888	1.25 - 1.50	30 - 40	24	600	4,920	2,230
RPP1178	0544-5891	1.50 - 2.00	40 - 50	24	600	5,820	2,640
<b>DOUBLE EYE DOUBLE WEAVE NON-METALLIC CABLE GRIP</b>							
RPP1182	0544-5894	1.25 - 1.50	30 - 40	24	600	9,860	4,470
RPP1183	0544-5897	1.50 - 2.00	40 - 50	24	600	11,880	5,390
RPP1184	0544-5900	2.00 - 2.50	50 - 65	24	600	15,900	7,210
RPP1185	0544-5903	2.50 - 3.00	65 - 76	24	600	15,900	7,210
RPP1186	0544-5906	3.00 - 4.00	76 - 100	24	600	15,900	7,210
RPP3813	0544-5909	4.00 - 5.00	102 - 127	60.6	1,540	15,900	7,210

Part #	Stock Code	Range		Lattice Length		Approx. Break Load	
		in	mm	in	mm	lb	kg
<b>SINGLE OFFSET EYE SINGLE WEAVE NON-METALLIC CABLE GRIP</b>							
RPP2810	0544-5912	0.38 - 0.75	10 - 20	24	600	2,460	1,115
RPP2811	0544-5915	0.75 - 1.25	20 - 30	24	600	3,580	1,620
RPP2921	0544-5918	1.00 - 1.50	25 - 36	24	600	3,580	1,620
RPP2812	0544-5921	1.25 - 1.50	30 - 40	24	600	4,920	2,230
RPP2813	0544-5924	1.50 - 2.00	40 - 50	24	600	5,820	2,640
<b>SINGLE OFFSET EYE DOUBLE WEAVE NON-METALLIC CABLE GRIP</b>							
RPP09342	0544-5927	0.50 - 1.00	13 - 25	39	990	8,093	3,671
RPP2814	0544-5930	1.25 - 1.50	30 - 40	24	600	9,860	4,470
RPP2815	0544-5933	1.50 - 2.00	40 - 50	24	600	11,880	5,390
RPP2816	0544-5936	2.00 - 2.50	50 - 65	24	600	15,900	7,210
RPP6005	0544-5939	2.50 - 3.00	64 - 76	39	990	15,000	6,696
RPP9000	0544-5942	2.50 - 3.00	64 - 76	30	762	5,000	2,268
RPP2817	0544-5945	2.50 - 3.00	64 - 76	24	600	15,900	7,210
RPP2818	0544-5948	3.00 - 4.00	76 - 100	24	600	15,900	7,210
RPP6006	0544-5951	3.00 - 4.00	76 - 100	24	610	15,000	6,696
RPP6007	0544-5954	4.00 - 5.00	102 - 127	24	610	15,000	6,696
<b>SINGLE OFFSET EYE LACE UP NON-METALLIC CABLE GRIP</b>							
RPP09323	0544-5957	0.62 - 1.00	15 - 25	59	1498	13,000	5,896
<b>DOUBLE OFFSET EYE NON-METALLIC CABLE GRIP</b>							
RPP8176	0544-5960	2.50 - 3.00	64 - 76	39	990	8,000	3,629
RPP09959	0544-5963	2.50 - 3.50	64 - 89	36	914	9,000	4,083
RPP6823	0544-5966	3.00 - 4.00	76 - 101	33	838	9,000	4,082



**SINGLE EYE**  
Cable Support Grip

**Closed Mesh**

Closed mesh for when end of cable is available. In 304 stainless steel.



**Single Eye Closed Mesh**

Part #	Stock Code	Range		Lattice Length		Approx. Break Load	
		in	mm	in	mm	lb	kg
RPP1893	0475-9065	0.50 - 0.63	12 - 16	9.7	247	567	255
RPP1894	0475-9068	0.63 - .0.75	16 - 19	9.7	247	890	400
RPP1895	0475-9071	0.75 - 1.00	19 - 25	13	331	1,040	470
RPP1896	0475-9074	1.00 - 1.25	25 - 31	13.5	344	1,700	770
RPP1897	0475-9077	1.25 - 1.50	31 - 38	15	382	1,700	770
RPP1898	0475-9080	1.50 - 1.75	38 - 44	16.5	420	1,700	770
RPP1899	0475-9083	1.75 - 2.00	44 - 50	20	509	2,300	1,040
RPP1900	0475-9086	2.00 - 2.50	50 - 63	21	535	3,400	1,540
RPP1901	0475-9089	2.50 - 3.00	63 - 76	24	611	3,400	1,540
RPP1902	0544-5969	3.00 - 3.50	76 - 89	26	662	5,000	2,265
RPP1903	0544-5972	3.50 - 4.00	89 - 102	29	738	5,000	2,265
RPP5032	0544-5975	3.50 - 4.50	89 - 114	46	1,168	5,000	2,265

**Split Mesh**

**Lace Closing**

Split mesh for when end of cable is not available. In 304 stainless steel.

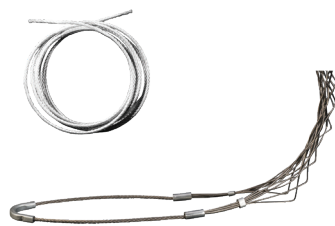

**Single Eye Split Mesh Lace Closing**

Part #	Stock Code	Range		Lattice Length		Approx. Break Load	
		in	mm	in	mm	lb	kg
RPP1904	0544-5978	0.50 - 0.63	12 - 16	9.7	247	567	255
RPP1905	0544-5981	0.63 - .0.75	16 - 19	9.7	247	890	400
RPP1906	0544-5984	0.75 - 1.00	19 - 25	13	331	1,040	470
RPP1907	0542-2437	1.00 - 1.25	25 - 31	13.5	344	1,700	770
RPP1908	0544-5987	1.25 - 1.50	31 - 38	15	382	1,700	770
RPP1909	0544-5990	1.50 - 1.75	38 - 44	16.5	420	1,700	770
RPP1910	0544-5993	1.75 - 2.00	44 - 50	20	509	2,300	1,040
RPP1911	0544-5996	2.00 - 2.50	50 - 63	21	535	3,400	1,540
RPP1912	0544-5999	2.50 - 3.00	63 - 76	24	611	3,400	1,540
RPP1913	0544-6002	3.00 - 3.50	76 - 89	26	662	5,000	2,265
RPP1914	0544-6005	3.50 - 4.00	89 - 102	29	738	5,000	2,265

**Single Eye Split Mesh Rod Closing**

**Rod Closing**

Split mesh rod for when end of cable is not available. Insert rod down the length of the grip to close.



Part #	Stock Code	Range		Lattice Length		Approx. Break Load	
		in	mm	in	mm	lb	kg
RPP2362	0544-6008	0.50 - 0.63	12 - 16	9.7	247	567	255
RPP2363	0544-6011	0.63 - .0.75	16 - 19	9.7	247	890	400
RPP2162	0544-6014	0.75 - 1.00	19 - 25	13	331	1,040	470
RPP2163	0542-2440	1.00 - 1.25	25 - 31	13.5	344	1,700	770
RPP2164	0544-6020	1.25 - 1.50	31 - 38	15	382	1,700	770
RPP2165	0544-6023	1.50 - 1.75	38 - 44	16.5	420	1,700	770
RPP2166	0544-6026	1.75 - 2.00	44 - 50	20	509	2,300	1,040
RPP2167	0544-6029	2.00 - 2.50	50 - 63	21	535	3,400	1,540
RPP2168	0544-6032	2.50 - 3.00	63 - 76	24	611	3,400	1,540
RPP2169	0544-6035	3.00 - 3.50	76 - 89	26	662	5,000	2,265
RPP2372	0544-6038	3.50 - 4.00	89 - 102	29	738	5,000	2,265

**DOUBLE EYE**  
Cable Support Grip

**Closed Mesh**

Two eyes for two connect/support points. Closed mesh for when end of cable is available. In 304 stainless steel.



**Double Eye Closed Mesh**

Part #	Stock Code	Range		Lattice Length		Approx. Break Load	
		in	mm	in	mm	lb	kg
RPP2038	0475-9107	0.50 - 0.63	12 - 16	9.7	247	512	230
RPP2039	0475-9113	0.63 - .0.75	16 - 19	9.7	247	740	335
RPP2040	0475-9110	0.75 - 1.00	19 - 25	13	331	1,000	450
RPP2041	0544-6041	1.00 - 1.25	25 - 31	15	344	1,540	695
RPP2042	0544-6044	1.25 - 1.50	31 - 38	16.5	382	1,540	695
RPP2043	0544-6047	1.50 - 1.75	38 - 44	20	420	2,010	910
RPP2044	0544-6050	1.75 - 2.00	44 - 50	21	509	3,230	1,465
RPP2045	0544-6053	2.00 - 2.50	50 - 63	24	535	3,230	1,465
RPP2046	0544-6056	2.50 - 3.00	63 - 76	26	611	4,000	1,815
RPP2047	0544-6059	3.00 - 3.50	76 - 89	29	662	4,000	1,815
RPP2048	0544-6062	3.50 - 4.00	89 - 102	29	738	4,001	1,815
RPP6404	0544-6065	4.00 - 4.50	102-114	30	762	4,000	1,815
RPP6405	0544-6068	4.50 - 5.00	114-127	30	762	4,000	1,815
RPP6406	0544-6071	5.00 - 5.50	127-140	30	762	4,000	1,815

**Split Mesh**

**Lace Closing**

Two eyes for two connect/support points. Split mesh for secure attachment and support when end of cable is not available. In 304 stainless steel.



**Double Eye Split Mesh Lace Closing**

Part #	Stock Code	Range		Lattice Length		Approx. Break Load	
		in	mm	in	mm	lb	kg
RPP2998	0544-6074	0.50 - 0.63	12 - 16	10	254	530	240
RPP2999	0544-6077	0.63 - .0.75	16 - 19	10	254	790	360
RPP3000	0544-6080	0.75 - 1.00	19 - 25	13	330	1,020	460
RPP3001	0544-6083	1.00 - 1.25	25 - 31	14	355	1,610	730
RPP3002	0544-6086	1.25 - 1.50	31 - 38	15	381	1,610	730
RPP3003	0544-6089	1.50 - 1.75	38 - 44	17	432	1,610	730
RPP3004	0544-6092	1.75 - 2.00	44 - 50	19	482	2,150	975
RPP3005	0544-6095	2.00 - 2.50	50 - 63	21	533	3,260	1,480
RPP3006	0544-6098	2.50 - 3.00	63 - 76	23	584	3,260	1,480
RPP3007	0544-6101	3.00 - 3.50	76 - 89	25	635	4,900	2,222
RPP3008	0544-6104	3.50 - 4.00	89 - 102	27	685	4,900	2,222

**Rod Closing**

Two eyes for two connect/support points. Split mesh rod for secure attachment and support when end of cable is not available. In 304 stainless steel.



**Double Eye Split Mesh Rod Closing**

Part #	Stock Code	Range		Lattice Length		Approx. Break Load	
		in	mm	in	mm	lb	kg
RPP3009	0544-6107	0.50 - 0.63	12 - 16	8.5	216	790	355
RPP3010	0544-6110	0.63 - .0.75	16 - 19	8.5	216	790	355
RPP3011	0544-6113	0.75 - 1.00	19 - 25	10.5	266	1,020	460
RPP3012	0544-6116	1.00 - 1.25	25 - 31	12.5	317	1,610	730
RPP3013	0544-6119	1.25 - 1.50	31 - 38	14.5	368	1,610	730
RPP3014	0544-6122	1.50 - 1.75	38 - 44	15.5	394	1,610	730
RPP3015	0544-6125	1.75 - 2.00	44 - 50	16.5	419	2,150	975
RPP3016	0544-6128	2.00 - 2.50	50 - 63	19.5	495	3,260	1,475
RPP3017	0544-6131	2.50 - 3.00	63 - 76	21.5	546	3,260	1,475
RPP3018	0544-6134	3.00 - 3.50	76 - 89	23.5	597	5,750	2,600
RPP3019	0544-6137	3.50 - 4.00	89 - 102	25.5	648	5,750	2,600

**OFFSET EYE  
Cable Support Grip**

**Closed Mesh**

Designed to support cable as it hangs vertically or horizontally. Closed mesh for when end of cable is available. In 304 stainless steel.



**Offset Eye Closed Mesh**

Part #	Stock Code	Range		Lattice Length		Approx. Break Load	
		in	mm	in	mm	lb	kg
RPP1915	0475-9098	0.50 - 0.63	12 - 16	9.7	247	512	230
RPP1916	0544-6140	0.63 - .075	16 - 19	9.7	247	740	335
RPP1917	0539-4141	0.75 - 1.00	19 - 25	13	331	1,000	450
RPP1918	0544-6143	1.00 - 1.25	25 - 31	13.5	344	1,540	695
RPP1919	0544-6146	1.25 - 1.50	31 - 38	15	382	1,540	695
RPP1920	0544-6149	1.50 - 1.75	38 - 44	16.5	420	1,540	910
RPP1921	0544-6152	1.75 - 2.00	44 - 50	20	509	2,010	1,465
RPP1922	0544-6155	2.00 - 2.50	50 - 63	21	535	3,230	1,465
RPP1923	0544-6158	2.50 - 3.00	63 - 76	24	611	3,230	1,815
RPP1924	0544-6161	3.00 - 3.50	76 - 89	26	662	4,000	1,815
RPP1925	0544-6164	3.50 - 4.00	89 - 102	29	738	4,000	1,815
RPP6408	0544-6167	4.00 - 4.50	102 - 114	28	711	4,000	1,815
RPP6409	0544-6170	4.50 - 5.00	114 - 127	28	711	4,000	1,815
RPP6410	0544-6173	5.00 - 5.50	127 - 140	28	711	4,000	1,815

**Split Mesh**

**Lace Closing**

Ideal for several support points along the same cable. Split mesh for when end of cable is not available. In 304 stainless steel.

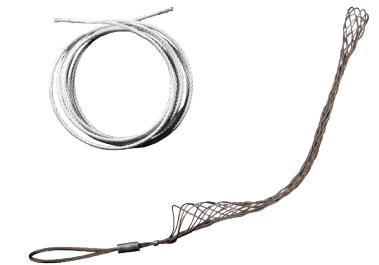

**Offset Eye Split Mesh Lace Closing**

Part #	Stock Code	Range		Lattice Length		Approx. Break Load	
		in	mm	in	mm	lb	kg
RPP1926	0544-6176	0.50 - 0.63	12 - 16	10	254	500	225
RPP1927	0544-6179	0.63 - .075	16 - 19	10	254	750	340
RPP1928	0544-6182	0.75 - 1.00	19 - 25	13	330	950	430
RPP1929	0544-6185	1.00 - 1.25	25 - 31	14	355	1,500	680
RPP1930	0544-6188	1.25 - 1.50	31 - 38	15	381	1,500	680
RPP1931	0544-6191	1.50 - 1.75	38 - 44	17	432	1,500	680
RPP1932	0544-6194	1.75 - 2.00	44 - 50	19	482	2,000	905
RPP1933	0544-6197	2.00 - 2.50	50 - 63	21	533	2,150	975
RPP1934	0544-6200	2.50 - 3.00	63 - 76	23	584	2,150	975
RPP1935	0544-6203	3.00 - 3.50	76 - 89	25	635	3,800	1,720
RPP1936	0544-6206	3.50 - 4.00	89 - 102	27	685	3,800	1,720

**Rod Closing**

Ideal for several support points along the same cable. Split mesh rod for when end of cable is not available. In 304 stainless steel.



**Offset Eye Split Mesh Rod Closing**

Part #	Stock Code	Range		Lattice Length		Approx. Break Load	
		in	mm	in	mm	lb	kg
RPP3031	0544-6209	0.50 - 0.63	12 - 16	7	178	500	225
RPP3032	0544-6212	0.63 - .075	16 - 19	9	229	750	340
RPP3033	0544-6215	0.75 - 1.00	19 - 25	10	254	950	430
RPP3034	0544-6218	1.00 - 1.25	25 - 31	12	305	1,500	680
RPP3035	0544-6221	1.25 - 1.50	31 - 38	14	359	1,500	680
RPP3036	0544-6224	1.50 - 1.75	38 - 44	15	381	1,500	680
RPP3037	0544-6227	1.75 - 2.00	44 - 50	16	406	2,000	905
RPP3038	0544-6230	2.00 - 2.50	50 - 63	19	483	3,100	975
RPP3039	0544-6233	2.50 - 3.00	63 - 76	20	508	3,100	975
RPP3040	0544-6236	3.00 - 3.50	76 - 89	21	533	4,300	1,720
RPP3041	0544-6239	3.50 - 4.00	89 - 102	21	533	4,900	1,720

**UNIVERSAL EYE  
Cable Support Grip**

**Closed Mesh**

Fitted with an adjustable eye for easy and secure attachment where the end of the cable is inserted into the support grip. In 304 stainless steel.



**Universal Eye Closed Mesh**

Part #	Stock Code	Range		Lattice Length		Approx. Break Load	
		in	mm	in	mm	lb	kg
RPP2664	0544-6242	0.50 - 0.63	12 - 16	10	254	530	240
RPP4272	0544-6245	0.58 - 0.68	14.7 - 17.3	12	305	1,050	469
RPP2665	0544-6248	0.63 - .075	16 - 19	10	254	790	360
RPP2666	0544-6251	0.75 - 1.00	19 - 25	13	330	1,020	460
RPP4273	0544-6254	0.75 - 0.87	19 - 22.1	13	330	1,390	620
RPP4274	0544-6257	0.87 - 1.00	22.1 - 25	14	355	1,790	799
RPP2667	0544-6260	1.00 - 1.25	25 - 31	14	355	1,610	730
RPP2324	0544-6263	1.25 - 1.50	31 - 38	15	381	1,610	730
RPP2668	0544-6266	1.50 - 1.75	38 - 44	17	432	1,610	730
RPP2669	0544-6269	1.75 - 2.00	44 - 50	19	483	2,150	975
RPP2670	0544-6272	2.00 - 2.50	50 - 63	21	533	3,260	1,480
RPP2671	0544-6275	2.50 - 3.00	63 - 76	23	584	3,260	1,480

**Split Mesh**

**Lace Closing**

Fitted with an adjustable eye for easy and secure attachment where the end of the cable is not available. In 304 stainless steel.



**Universal Eye Split Mesh Lace Closing**

Part #	Stock Code	Range		Lattice Length		Approx. Break Load	
		in	mm	in	mm	lb	kg
RPP2672	0544-6278	0.50 - 0.63	12 - 16	10	254	530	240
RPP2673	0544-6281	0.63 - .075	16 - 19	10	254	790	360
RPP2674	0544-6284	0.75 - 1.00	19 - 25	13	330	1,020	460
RPP2675	0544-6287	1.00 - 1.25	25 - 31	14	355	1,610	730
RPP2676	0544-6290	1.25 - 1.50	31 - 38	15	381	1,610	730
RPP2677	0544-6293	1.50 - 1.75	38 - 44	17	432	1,610	730
RPP2678	0544-6296	1.75 - 2.00	44 - 50	19	483	2,150	975
RPP2679	0544-6299	2.00 - 2.50	50 - 63	21	533	3,260	1,480
RPP2680	0544-6302	2.50 - 3.00	63 - 76	23	584	3,280	1,480
RPP2681	0544-6305	3.00 - 3.50	76 - 89	25	635	4,900	2,222
RPP2682	0544-6308	3.50 - 4.00	89 - 102	27	686	4,900	2,222

**Rod Closing**

Fitted with an adjustable eye for easy and secure attachment where the end of the cable is not available. In 304 stainless steel.



**Universal Eye Split Mesh Rod Closing**

Part #	Stock Code	Range		Lattice Length		Approx. Break Load	
		in	mm	in	mm	lb	kg
RPP2683	0544-6311	0.50 - 0.63	12 - 16	8.5	216	530	240
RPP2684	0544-6314	0.63 - .075	16 - 19	8.5	216	790	360
RPP2685	0544-6317	0.75 - 1.00	19 - 25	10.5	267	1,020	460
RPP2686	0544-6320	1.00 - 1.25	25 - 31	12.5	317	1,610	730
RPP2687	0544-6323	1.25 - 1.50	31 - 38	14.5	368	1,610	730
RPP2688	0544-6326	1.50 - 1.75	38 - 44	15.5	394	1,610	730

**HEAVY DUTY Cable Support Grips**

These grips are ideal for supporting heavy cable, conduit, or cylindrical objects. Used to support cables transitioning from overhead to underground. The overall diameter of the cable should fit within the listed range.

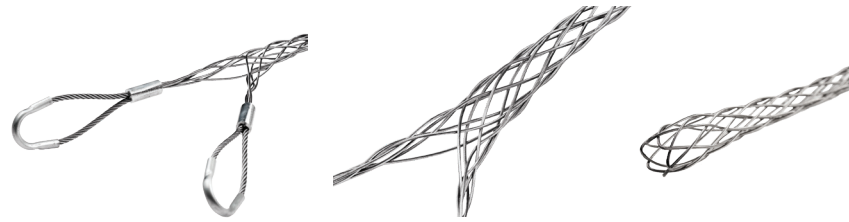

**Single Eye**

Part #	Stock Code	Range		Approx. Break Load	
		in	mm	lb	kg
RPP7065	0475-9116	0.50 - 0.63	13 - 16	1,370	621
RPP7066	0544-6329	0.63 - 0.75	16 - 19	2,060	944
RPP7067	0475-9119	0.75 - 1.00	19 - 25	2,060	944
RPP7068	0475-9122	1.00 - 1.25	25 - 32	2,678	1,216
RPP7069	0475-9125	1.25 - 1.50	32 - 38	4,490	2,037
RPP7070	0475-9128	1.50 - 1.75	38 - 44	4,490	2,037
RPP7071	0544-6332	1.75 - 2.00	44 - 51	5,000	2,269
RPP7072	0544-6335	2.00 - 2.50	51 - 63	8,940	4,056
RPP7073	0544-6338	2.50 - 3.00	63 - 76	8,940	4,056
RPP7074	0544-6341	3.00 - 3.50	76 - 87	13,420	6,089
RPP7075	0544-6344	3.50 - 4.00	87 - 102	13,420	6,089

**Double Eye**

Part #	Stock Code	Range		Approx. Break Load	
		in	mm	lb	kg
RPP3057	0544-6347	0.50 - 0.63	13 - 16	1,370	621
RPP3058	0544-6350	0.63 - 0.75	16 - 19	2,080	944
RPP3059	0544-6353	0.75 - 1.00	19 - 25	2,080	944
RPP3060	0544-6356	1.00 - 1.25	25 - 31	2,870	1,302
RPP3061	0475-9131	1.25 - 1.50	31 - 38	4,490	2,037
RPP3062	0544-6359	1.50 - 1.75	38 - 44	4,490	2,037
RPP3063	0544-6362	1.75 - 2.00	44 - 50	5,000	2,268
RPP3064	0544-6365	2.00 - 2.50	50 - 63	8,940	4,056
RPP3065	0544-6368	2.50 - 3.00	63 - 76	8,940	4,056
RPP3066	0544-6371	3.00 - 3.50	76 - 89	12,000	5,445
RPP3067	0544-6374	3.50 - 4.00	89 - 102	12,000	5,445

**Single Eye Lace-Up**

Part #	Stock Code	Range		Approx. Break Load	
		in	mm	lb	kg
RPP6907	0544-6377	0.50 - 0.63	13 - 16	1,370	621
RPP6908	0544-6380	0.63 - 0.75	16 - 19	2,080	944
RPP6909	0544-6383	0.75 - 1.00	19 - 25	2,080	944
RPP6910	0544-6386	1.00 - 1.25	25 - 32	2,670	1,211
RPP6911	0544-6389	1.25 - 1.50	32 - 38	4,490	2,037
RPP6912	0544-6392	1.50 - 1.75	38 - 44	4,490	2,037
RPP6913	0544-6395	1.75 - 2.00	44 - 51	5,000	2,269
RPP6914	0544-6398	2.00 - 2.50	51 - 63	8,940	4,056
RPP6915	0544-6401	2.50 - 3.00	63 - 76	8,940	4,056
RPP6916	0544-6404	3.00 - 3.50	76 - 87	13,420	6,089
RPP6917	0544-6407	3.50 - 4.00	87 - 102	13,420	6,089

**Double Eye Lace-Up**

Part #	Stock Code	Range		Approx. Break Load	
		in	mm	lb	kg
RPP7087	0544-6410	0.50 - 0.63	13 - 16	1,370	621
RPP7088	0544-6413	0.63 - 0.75	16 - 19	2,080	944
RPP7089	0544-6416	0.75 - 1.00	19 - 25	2,080	944
RPP7090	0544-6419	1.00 - 1.25	25 - 32	2,670	1,211
RPP7091	0544-6422	1.25 - 1.50	32 - 38	4,490	2,037
RPP7092	0544-6425	1.50 - 1.75	38 - 44	4,490	2,037
RPP7093	0544-6428	1.75 - 2.00	44 - 51	5,000	2,269
RPP7094	0544-6431	2.00 - 2.50	51 - 63	8,940	4,056
RPP7095	0544-6434	2.50 - 3.00	63 - 76	8,940	4,056
RPP7096	0544-6437	3.00 - 3.50	76 - 87	13,420	6,089
RPP7097	0544-6440	3.50 - 4.00	87 - 102	13,420	6,089

**Single Eye Rod Closing**

Part #	Stock Code	Range		Approx. Break Load	
		in	mm	lb	kg
RPP7076	0544-6443	0.50 - 0.63	13 - 16	1370	621
RPP7077	0544-6446	0.63 - 0.75	16 - 19	2080	944
RPP7078	0544-6449	0.75 - 1.00	19 - 25	2080	944
RPP7079	0544-6452	1.00 - 1.25	25 - 32	2670	1211
RPP7080	0544-6455	1.25 - 1.50	32 - 38	4490	2037
RPP7081	0544-6458	1.50 - 1.75	38 - 44	4490	2037
RPP7082	0544-6461	1.75 - 2.00	44 - 51	5000	2269
RPP7083	0544-6464	2.00 - 2.50	51 - 63	8940	4056
RPP7084	0544-6467	2.50 - 3.00	63 - 76	8940	4056
RPP7085	0544-6470	3.00 - 3.50	76 - 87	13420	6089
RPP7086	0544-6473	3.50 - 4.00	87 - 102	13420	6089

**Double Eye Rod Closing**

Part #	Stock Code	Range		Approx. Break Load	
		in	mm	lb	kg
RPP7098	0544-6476	0.50 - 0.63	13 - 16	1,370	621
RPP7099	0544-6479	0.63 - 0.75	16 - 19	2,080	944
RPP7100	0544-6482	0.75 - 1.00	19 - 25	2,080	944
RPP7101	0544-6485	1.00 - 1.25	25 - 32	2,670	1,211
RPP7102	0544-6488	1.25 - 1.50	32 - 38	4,490	2,037
RPP7103	0544-6491	1.50 - 1.75	38 - 44	4,490	2,037
RPP7104	0544-6494	1.75 - 2.00	44 - 51	5,000	2,269
RPP7105	0544-6497	2.00 - 2.50	51 - 63	8,940	4,056
RPP7106	0544-6500	2.50 - 3.00	63 - 76	8,940	4,056
RPP7107	0544-6503	3.00 - 3.50	76 - 87	13,420	6,089
RPP7108	0544-6506	3.50 - 4.00	87 - 102	13,420	6,089

**BUS DROP Cable Support Grip**

This lightweight grip is perfect for supporting cables in data centers, control centers, and wiring-to-rack applications.



**SERVICE DROP Cable Support Grip**

This grip has an extended eye that allows for easy installation and hanging from conveniently placed connection points. Used to support cables in manufacturing, industrial, and open space environments.



**NYLON CABLE SUPPORT Grip for Fiber**

The nylon material of this grip ensures there's no interference or damage caused to the supported cables. Used for supporting lightweight cables (1" to 2") and for positioning.



Part #	Stock Code	Range		Eye Length		Approx. Break Load	
		in	mm	in	mm	lb	kg
RPP6969	0454-6809	0.24 - 0.32	6.1 - 8.1	3.5	88.9	350	158
RPP6970	0454-6812	0.32 - 0.43	8.1 - 10.9	4	101.6	450	204
RPP6971	0454-6815	0.43 - 0.56	10.9 - 14.2	4.75	120.6	550	249
RPP6972	0454-6818	0.56 - 0.73	14.2 - 18.5	6	152.4	1,000	453
RPP6973	0454-6821	0.73 - 0.85	18.5 - 21.6	6.75	171.4	1,400	635
RPP6974	0454-6824	0.85 - 1.00	21.6 - 25.4	8	203.2	1,400	635
RPP6975	0454-6827	1.00 - 1.25	25.4 - 31.7	9.5	241.3	1,500	680

Part #	Stock Code	Range		Eye Length		Approx. Break Load	
		in	mm	in	mm	lb	kg
RPP7684	0544-6509	0.22 - 0.32	5.6 - 8.1	9	229	1,100	499
RPP7685	0544-6512	0.30 - 0.43	7.6 - 10.9	9	229	1,100	499
RPP7686	0544-6515	0.41 - 0.56	10.4 - 14.2	9	229	1,100	499
RPP7687	0544-6518	0.53 - 0.73	13.5 - 18.5	9	229	1,100	499
RPP7688	0544-6521	0.70 - 0.85	17.8 - 21.6	9	229	1,900	861
RPP7689	0544-6524	0.82 - 1.00	20.8 - 25.4	9	229	1,900	861
RPP7690	0544-6527	0.96 - 1.25	24.4 - 31.7	7	178	1,900	861

Part #	Stock Code	Part #	Stock Code	Range		Eye Length		Approx. Break Load	
				in	mm	in	mm	lb	kg
Offset Eye		Double Eye							
RPP7789	0544-6551	RPP7790	0544-6530	0.40 - 0.47	10.2 - 12	6	152.4	200	91
RPP8191	0544-6554	RPP8197	0544-6533	0.45 - 0.63	7.6 - 10.9	7	177.8	200	91
RPP8192	0544-6557	RPP8198	0544-6536	0.84 - 0.89	10.4 - 14.2	8	203	300	136
RPP8193	0544-6560	RPP8199	0544-6539	1.08 - 1.20	27.4 - 30.5	13	330	300	136
RPP8194	0544-6563	RPP8200	0544-6542	1.54 - 1.67	39 - 42.4	8	203	550	249
RPP8195	0544-6566	RPP8201	0544-6545	1.98 - 2.04	50.3 - 51.8	12	305	550	249
RPP8196	0544-6569	RPP8202	0544-6548	2.35 - 2.36	59.6 - 60	14	356	650	295
RPP8196	0544-6569	RPP8202	0544-6548	2.35 - 2.36	59.6 - 60	14	356	650	295

**CONDUIT RISER**  
Stainless Steel • Cable Support Grip

Conduit Riser Grips are designed to support cables within conduit. Designed to match standard conduit sizes. These grips come in single and double weave as indicated in the chart below. Also available in Split Ring design for supporting cable already installed or when the end of the cable is not available.

Contact 772.408.5211 for additional sizes and styles.

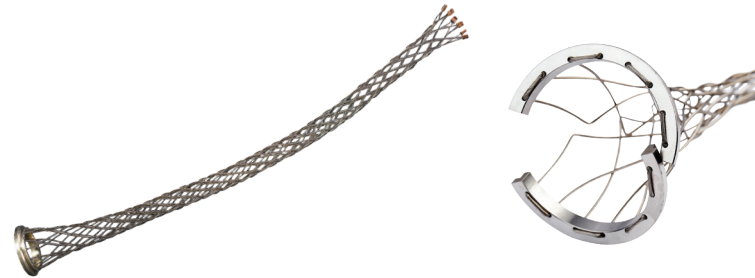

RPP Comparison Reference Numbers and Approximate Breaking Strengths (Lb)																				
Cable Sizes Diameter Inches																				
Length Inches																				
Conduit size inches	8	9	11	12	12	14	15	17	17	18	19	18	21	20	20	21	21	24	27	27
0.75	RPP2690 530																			
1	RPP2691 490	RPP2694 790																		
1.25	RPP2692 450	RPP2695 740	RPP2698 1,030																	
1.5		RPP2696 690	RPP2699 970	RPP2701 1,610																
2	RPP2693 370	RPP2697 640	RPP2700 920	RPP2702 1,520	RPP2704 1,610															
2.5				RPP2705 1,510	RPP2707 1,610	RPP2708 2,150														
3			RPP2703 1,340	RPP2706 1,400	RPP2709 1,490	RPP2710 1,990	RPP2711 3,260													
3.5							RPP2714 2,970	RPP2716 3,260												
4						RPP2712 1,670	RPP2713 2,680		RPP2715 2,890				RPP2717 4,080							
4.5										Split Rod RPP4282 4,080										
5								RPP5645* 2,150	RPP2719 2,150		RPP5646* 3,130 Split Rod RPP4283 3,130	RPP5085 3,130	RPP2721 2,860			RPP2723 3,130				
6												RPP2722 2,240	RPP5647 2,240	RPP2724 2,240	RPP4755 2,240	RPP4276 2,245	RPP3259 4,995	RPP4284 4,995		

\* Indicates Double Weave

**HOOKED EYE**  
Conduit • Cable Support Grip

This heavy duty grip is used for outdoor riser pole applications.



Part #	Stock Code	Range		Lattice Weave	Lattice Length		Approx. Break Load	
		in	mm		in	mm	lb	kg
RPP5430	0544-6572	2.25 - 2.75	57 - 70	Double	21	533	2,000	910
RPP5268	0544-6575	3.25 - 3.75	82 - 95	Double	21	533	6,500	2,902
RPP5062	0544-6578	3.50 - 4.25	89 - 108	Double	21	533	6,500	2,902
RPP4301	0544-6581	4.0 - 4.50	102 - 114	Double	21	533	6,000	2,678

**CONNECTOR/BOX**  
Stainless Steel • Grip

This grip is designed with a ring to support electric cable from termination point to reduce strain on the connections.

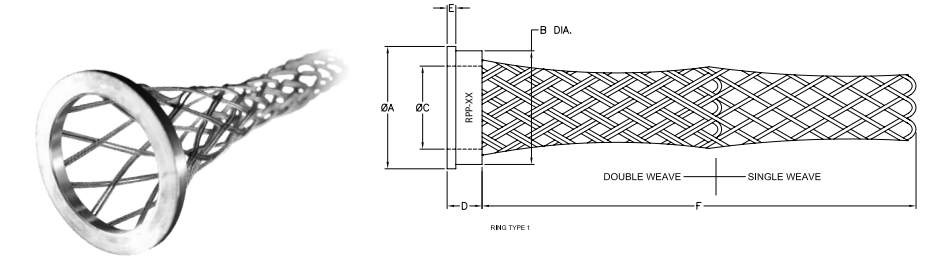

Part #	Stock Code	Cable Dia. Min.	Cable Dia. Max.	Ø A	B	Ø C	D	E	F	Approx. Breaking Strength
		in (mm)	in (mm)	in (mm)	in (mm)	in (mm)	in (mm)	in (mm)	in (mm)	lb (kg)
RPP2208	0544-6584	0.2 (5.1)	0.25 (6.4)	1.25 (31.8)	1.12 (28.4)	0.31 (7.9)	0.281 (7.1)	0.125 (3.2)	3 (76)	500 (225)
RPP2209	0544-6587	0.31 (7.9)	0.375 (9.5)	1.25 (31.8)	1.12 (28.4)	0.437 (11.1)	0.281 (7.1)	0.125 (3.2)	4 (102)	750 (340)
RPP2210	0544-6590	0.41 (10.4)	0.5 (12.7)	1.25 (31.8)	1.12 (28.4)	0.562 (14.3)	0.281 (7.1)	0.125 (3.2)	5 (127)	750 (340)
RPP2211	0544-6593	0.5 (12.7)	0.625 (15.9)	1.25 (31.8)	1.12 (28.4)	0.687 (17.4)	0.281 (7.1)	0.125 (3.2)	6 (152)	1,200 (540)
RPP2212	0544-6596	0.61 (15.5)	0.75 (19.1)	1.25 (31.8)	1.12 (28.4)	0.812 (20.6)	0.281 (7.1)	0.125 (3.2)	7 (178)	1,200 (540)
RPP2213	0544-6599	0.71 (18.0)	0.875 (22.2)	1.25 (31.8)	1.12 (28.4)	0.937 (23.8)	0.281 (7.1)	0.125 (3.2)	7.5 (178)	1,000 (450)
RPP2214	0544-6602	0.77 (19.6)	0.937 (23.8)	1.25 (31.8)	1.12 (28.4)	0.948 (24.1)	0.219 (5.6)	-	8 (203)	800 (360)
RPP2215	0544-6605	0.31 (7.9)	0.375 (9.5)	1.75 (44.5)	1.62 (41.1)	0.437 (11.1)	0.281 (7.1)	0.125 (3.2)	4 (102)	500 (225)
RPP2216	0544-6608	0.41 (10.4)	0.5 (12.7)	1.75 (44.5)	1.62 (41.1)	0.562 (14.3)	0.281 (7.1)	0.125 (3.2)	5 (127)	750 (340)
RPP2217	0544-6611	0.5 (12.7)	0.625 (15.9)	1.75 (44.5)	1.62 (41.1)	0.687 (17.4)	0.281 (7.1)	0.125 (3.2)	6 (152)	1,000 (450)
RPP2218	0544-6614	0.61 (15.5)	0.75 (19.1)	1.75 (44.5)	1.62 (41.1)	0.812 (20.6)	0.281 (7.1)	0.125 (3.2)	7 (178)	1,000 (450)
RPP2219	0544-6617	0.71 (18.0)	0.875 (22.2)	1.75 (44.5)	1.62 (41.1)	0.937 (23.8)	0.281 (7.1)	0.125 (3.2)	7.5 (190)	1,000 (450)
RPP2220	0544-6620	0.82 (20.8)	1 (25.4)	1.75 (44.5)	1.62 (41.1)	1.062 (27.0)	0.281 (7.1)	0.125 (3.2)	8.5 (215)	1,000 (450)
RPP2221	0544-6623	0.915 (23.2)	1.125 (28.6)	1.75 (44.5)	1.62 (41.1)	1.187 (30.1)	0.281 (7.1)	0.125 (3.2)	9 (229)	1,500 (680)
RPP2222	0544-6626	1.02(25.9)	1.25 (31.8)	1.75 (44.5)	1.62 (41.1)	1.312 (33.3)	0.281 (7.1)	0.125 (3.2)	10 (254)	1,000 (450)
RPP2223	0544-6629	1.18 (30.0)	1.437 (36.5)	1.75 (44.5)	1.62 (41.1)	1.448 (36.8)	0.219 (5.6)	-	10.5 (265)	500 (225)
RPP2224	0544-6632	0.5 (12.7)	0.625 (15.9)	2.25 (57.2)	2.12 (53.8)	0.687 (17.4)	0.281 (7.1)	0.125 (3.2)	6 (152)	1,000 (450)
RPP2225	0544-6635	0.71 (18.0)	0.875 (22.2)	2.25 (57.2)	2.12 (53.8)	0.937 (23.8)	0.281 (7.1)	0.125 (3.2)	7 1/2 (178)	1,000 (450)
RPP7384	0544-6638	0.82 (20.8)	1.00 (25.4)	2.25 (57.2)	2.12 (53.8)	1.62 (41)	0.281 (7.1)	0.125 (3.2)	8 1/2 (215)	1,000 (450)
RPP2226	0544-6641	0.915 (23.2)	1.125 (28.6)	2.25 (57.2)	2.12 (53.8)	1.187 (30.1)	0.281 (7.1)	0.125 (3.2)	9 (229)	1,500 (680)
RPP2227	0544-6644	1.02 (25.9)	1.25 (31.8)	2.25 (57.2)	2.12 (53.8)	1.312 (33.3)	0.281 (7.1)	0.125 (3.2)	10 (254)	1,800 (815)
RPP2228	0544-6647	1.22 (31.0)	1.5 (38.1)	2.25 (57.2)	2.12 (53.8)	1.562 (39.7)	0.281 (7.1)	0.125 (3.2)	11 (279)	1,800 (815)
RPP2229	0544-6650	1.43 (36.3)	1.75 (44.5)	2.25 (57.2)	2.12 (53.8)	1.812 (46.0)	0.281 (7.1)	0.125 (3.2)	13 (330)	700 (315)
RPP2230	0544-6653	1.18 (30.0)	1.937 (49.2)	2.25 (57.2)	2.12 (53.8)	1.948 (49.5)	0.219 (5.6)	-	14.5 (365)	350 (155)
RPP2231	0544-6656	0.82 (20.8)	1 (25.4)	2.75 (69.9)	2.62 (66.5)	1.062 (27.0)	0.281 (7.1)	0.125 (3.2)	8.5 (215)	1,000 (450)
RPP2232	0544-6659	1.02 (25.9)	1.25 (31.8)	2.75 (69.9)	2.62 (66.5)	1.312 (33.3)	0.281 (7.1)	0.125 (3.2)	10 (254)	1,500 (680)
RPP2233	0544-6662	1.22 (31.0)	1.5 (38.1)	2.75 (69.9)	2.62 (66.5)	1.562 (39.7)	0.281 (7.1)	0.125 (3.2)	11 (279)	1,500 (680)
RPP2234	0544-6665	1.43 (36.3)	1.75 (44.5)	2.75 (69.9)	2.62 (66.5)	1.812 (46.0)	0.281 (7.1)	0.125 (3.2)	13 (330)	1,800 (815)
RPP2235	0544-6668	1.64 (41.7)	2 (50.8)	2.75 (69.9)	2.62 (66.5)	2.062 (52.4)	0.281 (7.1)	0.125 (3.2)	15 (381)	1,800 (815)
RPP2236	0544-6671	1.84 (46.7)	2.25 (57.2)	2.75 (69.9)	2.62 (66.5)	2.312 (58.7)	0.281 (7.1)	0.125 (3.2)	16 (406)	1,500 (680)
RPP2237	0544-6674	2.062 (52.4)	2.469 (62.7)	2.75 (69.9)	2.62 (66.5)	2.489 (63.2)	0.219 (5.6)	-	17.5 (444)	1,500 (680)
RPP2238	0544-6677	1.375 (34.9)	1.75 (44.5)	3.25 (82.6)	3.12 (79.2)	1.812 (46.0)	0.281 (7.1)	0.125 (3.2)	13 (330)	2,000 (905)
RPP2239	0544-6680	1.75 (44.5)	2 (50.8)	3.25 (82.6)	3.12 (79.2)	2.062 (52.4)	0.281 (7.1)	0.125 (3.2)	15 (381)	2,000 (905)
RPP2240	0544-6683	1.84 (46.7)	2.25 (57.2)	3.25 (82.6)	3.12 (79.2)	2.312 (58.7)	0.281 (7.1)	0.125 (3.2)	16 (406)	2,000 (905)
RPP2241	0544-6686	2.125 (54.0)	2.5 (63.5)	3.25 (82.6)	3.12 (79.2)	2.562 (65.1)	0.281 (7.1)	0.125 (3.2)	17.5 (444)	2,000 (905)
RPP2242	0544-6689	2.5 (63.5)	2.875 (73.0)	3.25 (82.6)	3.12 (79.2)	2.918 (74.1)	0.219 (5.6)	-	19 (483)	2,000 (905)

**DELUXE  
Cord Grip**

This grip provides strain relief and bend support for cables running into machinery and connection boxes. Available with straight male, 90° male, 45° male, and straight female connections.



Range	Part #	Stock Code	Part #	Stock Code	Part #	Stock Code	Part #	Stock Code
in	mm	Straight Male	90° Male	45° Male	Straight Female			
<b>3/8" NPT</b>								
0.19 - 0.25	4.8 - 6.4	RPP7713	0544-6692	RPP7717	0544-6704	-	-	-
0.25 - 0.31	6.4 - 7.9	RPP7714	0544-6695	RPP7718	0544-6707	-	-	-
0.31 - 0.38	7.9 - 9.7	RPP7715	0544-6698	RPP7719	0544-6710	-	-	-
0.38 - 0.50	9.7 - 12.7	RPP7716	0544-6701	RPP7720	0544-6713	-	-	-
<b>1/2" NPT</b>								
0.19 - 0.25	4.8 - 6.4	RPP7721	0475-9020	RPP7727	0544-6722	RPP7731	0544-6734	RPP7735
0.25 - 0.38	6.4 - 9.6	RPP7722	0544-6716	RPP7728	0544-6725	RPP7732	0544-6737	RPP7736
0.38 - 0.50	9.7 - 12.7	RPP7723	0475-9023	RPP7729	0544-6728	RPP7733	0544-6740	RPP7737
0.50 - 0.63	12.7 - 16.0	RPP7724	0475-9026	RPP7730	0544-6731	RPP7734	0544-6743	RPP7738
0.63 - 0.75	16.0 - 19.1	RPP7725	0475-9029	-	-	-	-	-
0.75 - 0.88	19.1 - 22.4	RPP7726	0532-2060	-	-	-	-	-
<b>3/4" NPT</b>								
0.25 - 0.38	6.4 - 9.7	RPP7739	0544-6758	RPP7744	0544-6761	RPP7748	0544-6770	RPP7752
0.38 - 0.50	9.7 - 12.7	RPP7740	0475-9032	RPP7745	0544-6764	RPP7749	0544-6773	RPP7753
0.50 - 0.63	12.7 - 16.0	RPP7741	0475-9035	RPP7746	0475-9044	RPP7750	0544-6776	RPP7754
0.63 - 0.75	16.0 - 19.1	RPP7742	0474-0276	RPP7747	0544-6767	RPP7751	0544-6779	RPP7755
0.75 - 0.88	19.1 - 22.4	RPP7743	0475-9041	-	-	-	-	-
<b>1" NPT</b>								
0.44 - 0.56	11.2 - 14	RPP7887	0544-6794	RPP7894	0544-6809	RPP7899	0544-6824	RPP7904
0.56 - 0.69	14 - 17.5	RPP7888	0544-6797	RPP7895	0544-6812	RPP7900	0544-6827	RPP7905
0.63 - 0.75	16 - 19.1	RPP7889	0544-6800	RPP7896	0544-6815	RPP7901	0544-6830	RPP7906
0.75 - 0.88	19.1 - 22.4	RPP7890	0475-9047	RPP7897	0544-6818	RPP7902	0544-6833	RPP7907
0.88 - 1.00	22.4 - 25.4	RPP7891	0475-9050	RPP7898	0544-6821	RPP7903	0544-6836	RPP7908
1.00 - 1.13	25.4 - 28.7	RPP7892	0544-6803	-	-	-	-	-
1.13 - 1.25	28.7 - 31.8	RPP7893	0544-6806	-	-	-	-	-
<b>1.25" NPT</b>								
0.75 - 0.88	19.1 - 22.4	RPP7909	0544-6854	RPP7914	0544-6866	-	-	-
0.88 - 1.00	22.4 - 25.4	RPP7910	0544-6857	RPP7915	0544-6869	-	-	-
1.00 - 1.13	25.4 - 28.7	RPP7911	0544-6860	RPP7916	0544-6872	-	-	-
1.13 - 1.25	28.7 - 31.8	RPP7912	0475-9053	RPP7917	0544-6875	-	-	-
1.25 - 1.38	31.8 - 35.1	RPP7913	0544-6863	RPP7918	0544-6878	-	-	-
<b>1.5" NPT</b>								
0.75 - 0.88	19.1 - 22.4	RPP7919	0544-6881	RPP7929	0544-6908	-	-	-
0.88 - 1.00	22.4 - 25.4	RPP7920	0544-6884	RPP7930	0544-6911	-	-	-
1.00 - 1.13	25.4 - 28.7	RPP7921	0475-9056	RPP7931	0544-6914	-	-	-
1.13 - 1.25	28.7 - 31.8	RPP7922	0544-6887	RPP7932	0544-6917	-	-	-
1.25 - 1.38	31.8 - 35.1	RPP7923	0544-6890	RPP7933	0544-6920	-	-	-
1.31 - 1.44	33.3 - 36.6	RPP7924	0544-6893	-	-	-	-	-
1.44 - 1.56	36.6 - 39.6	RPP7925	0544-6896	-	-	-	-	-
1.56 - 1.69	39.6 - 43.0	RPP7926	0544-6899	-	-	-	-	-
1.69 - 1.81	43.0 - 46.0	RPP7927	0544-6902	-	-	-	-	-
1.75 - 1.88	44.5 - 47.8	RPP7928	0544-6905	-	-	-	-	-

**Deluxe Cord Grips (Continued)**

Range	Part #	Stock Code	Part #	Stock Code	Part #	Stock Code	Part #	Stock Code
in	mm	Straight Male	90° Male	45° Male	Straight Female			
<b>2" NPT</b>								
1.25 - 1.38	31.8 - 35.1	RPP7934	0544-6923	RPP7945	0544-6956	-	-	-
1.31 - 1.44	33.3 - 36.6	RPP7935	0544-6926	RPP7946	0544-6959	-	-	-
1.44 - 1.56	36.6 - 39.6	RPP7936	0544-6929	RPP7947	0544-6962	-	-	-
1.56 - 1.69	39.6 - 43.0	RPP7937	0544-6932	RPP7948	0544-6965	-	-	-
1.69 - 1.81	43.0 - 46.0	RPP7938	0544-6935	RPP7949	0544-6968	-	-	-
1.75 - 1.88	44.5 - 47.8	RPP7939	0544-6938	RPP7950	0544-6971	-	-	-
1.81 - 1.94	45.9 - 49.3	RPP7940	0544-6941	-	-	-	-	-
1.94 - 2.06	49.3 - 52.3	RPP7941	0544-6944	-	-	-	-	-
2.06 - 2.19	52.3 - 55.5	RPP7942	0544-6947	-	-	-	-	-
2.19 - 2.31	55.5 - 58.7	RPP7943	0544-6950	-	-	-	-	-
2.31 - 2.44	58.7 - 31.9	RPP7944	0544-6953	-	-	-	-	-
<b>3/8" NPT</b>								
1.69 - 1.81	43.0 - 46.0	RPP7951	0544-6974	-	-	-	-	-
1.81 - 1.94	45.9 - 49.3	RPP7952	0544-6977	-	-	-	-	-
1.94 - 2.06	49.3 - 52.3	RPP7953	0544-6980	-	-	-	-	-
2.06 - 2.19	52.3 - 55.5	RPP7954	0544-6983	-	-	-	-	-
2.19 - 2.31	55.5 - 58.7	RPP7955	0544-6986	-	-	-	-	-
2.31 - 2.44	58.7 - 31.9	RPP7956	0544-6989	-	-	-	-	-
<b>3.0" NPT</b>								
1.69 - 1.81	43.0 - 46.0	RPP7957	0544-6992	-	-	-	-	-
1.81 - 1.94	45.9 - 49.3	RPP7958	0544-6995	-	-	-	-	-
1.94 - 2.06	49.3 - 52.3	RPP7959	0542-7918	-	-	-	-	-
2.06 - 2.19	52.3 - 55.5	RPP7960	0544-6998	-	-	-	-	-
2.19 - 2.31	55.5 - 58.7	RPP7961	0544-7001	-	-	-	-	-
2.31 - 2.44	58.7 - 31.9	RPP7962	0544-7004	-	-	-	-	-
2.44 - 2.63	62.0 - 66.5	RPP7963	0544-7007	-	-	-	-	-
2.63 - 2.81	66.5 - 71.4	RPP7964	0475-9059	-	-	-	-	-
2.81 - 3.00	71.4 - 76.2	RPP7965	0544-7010	-	-	-	-	-
3.00 - 3.25	76.2 - 82.6	RPP7966	0544-7013	-	-	-	-	-

**DUST-TIGHT  
Cord Grip**

This grip provides strain relief and bend support for cables running into machinery and connection boxes. Available with straight male, 90° male, 45° male, and straight female connections.



Range	Size	Part #	Stock Code	Part #	Stock Code
in	mm	Insulated		Non-insulated	
0.22 - 0.32	5.6 - 8.1	RPP7674	0454-6782	RPP7756	0544-7016
0.30 - 0.43	7.6 - 10.9	RPP7675	0454-6785	RPP7757	0544-7019
0.40 - 0.54	10.1 - 13.7	RPP7676	0454-6788	RPP7758	0544-7022
0.52 - 0.73	13.2 - 18.5	RPP7677	0454-6791	RPP7759	0544-7025
0.70 - 0.97	17.8 - 24.6	RPP7678	0454-6794	RPP7760	0544-7028
0.94 - 1.25	23.8 - 31.8	RPP7679	0454-6797	RPP7761	0544-7031
1.20 - 1.50	30.5 - 38.1	RPP7680	0454-6800	-	-
1.40 - 1.75	38.1 - 44.5	RPP7681	0454-6803	-	-
1.62 - 2.00	41.1 - 50.8	RPP7682	0454-6806	-	-
2.00 - 2.45	50.8 - 62.2	RPP7683	0543-9990	-	-

CABLE CONTROL & GUIDANCE

CABLE LAYING  
Roller Grip



RPP2395

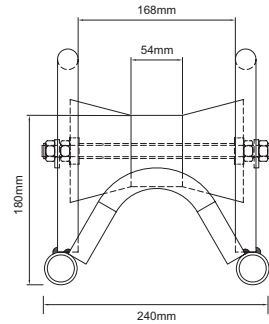

This grip is suitable for power, telecom, and utility installations, and can bridge existing trenches or ducts.

Part #	Stock Code	Base Footprint		Roller Height		Handle Height	
		in	mm	in	mm	in	mm
RPP2395	0544-7034	12 x 9 1/2	305 x 240	7 1/8	180	10	255

Other cable laying roller configurations are also available, as shown below. Contact 772.408.5211 for more details.



RPP8209

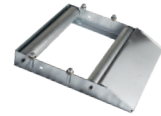

RPP8267



RPP8269

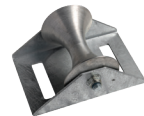

RPP8268



RPP8270



RPP8210

TRI & QUAD  
Pulling Sling Grip

Available in three-leg or four-leg versions, this staggered pulling sling is designed to pull multiple conductors at the same time, while minimizing the diameter of the pulling bundle. Suggested swivels are listed.

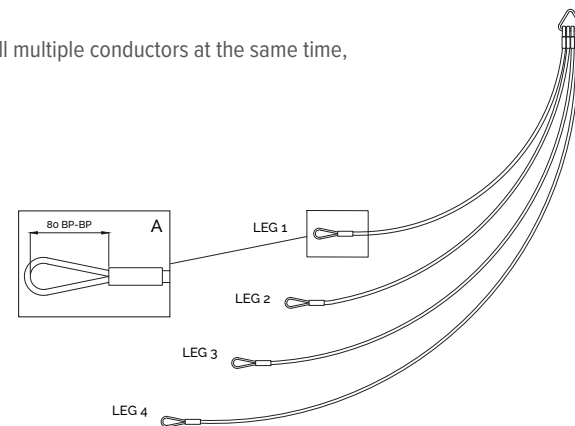

Part #	Stock Code	Leg 1 Length		Leg 2 Length		Leg 3 Length		Leg 4 Length		Head of Sling Swivel Suggestion	Stock Code	Leg Swivel Suggestion	Stock Code
		in	mm	in	mm	in	mm	in	mm				
RPP2264	0544-7037	20.5	520	34.65	880	52.75	1340	N/A	N/A	RPP2092	0544-5117	RPP2091	0544-5114
RPP2265	0544-7040	20.5	520	34.65	880	52.75	1340	69.3	1760	RPP2092	0544-5117	RPP2092	0544-5117

Minimum break load – 5,000 lb

CABLE SUPPORT GRIPS FOR EVERY APPLICATION:

- Alternative Energy Wind Farms & Turbines
- Aquatic
- Cell Towers
- Conduit Risers
- Data Centers
- Fish Farms
- Machine Shops
- Manufacturing
- Mining
- Oil & Gas Service Loop
- Utility Poles
- Waste Water

WIND TURBINE • SUPPORT GRIP - HEAVY DUTY • THIMBLE OFFSET EYE GRIPS

RPP has a range of cable grips tailored for use in:

- Cable installation - on-shore and off-shore
- Cable support inside wind turbines
- Cable management

Special features have been adapted to allow for minimal contact with the cable while still allowing excellent work loads and cable support.

This grip is manufactured from 316 stainless steel and provides cable support and control inside the wind turbine. It features rounded copper ferrules and offers reduced cable contact for high vibration environments. Custom grips can be adapted to meet any requirements.

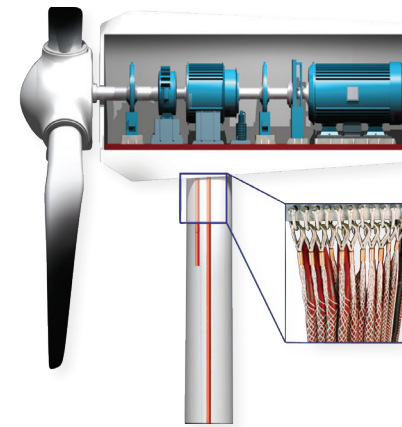

Part #	Stock Code	Range		Lattice Length		Approx. Break Load	
		in	mm	in	mm	lb	kg
RPP2844	0544-7043	0.31 - 0.40	8 - 10	25	635	1,485	670
RPP2845	0544-7046	0.40 - 0.60	10 - 15	26	660	2,295	1,040
RPP2846	0544-7049	0.60 - 0.80	15 - 20	28	711	2,900	1,315
RPP2847	0544-7052	0.80 - 0.99	20 - 25	29	736	4,550	2,080
RPP2848	0544-7055	1.0 - 1.19	25 - 30	29	736	5,450	2,475
RPP2849	0544-7058	1.20 - 1.58	30 - 40	31	787	7,800	3,575
RPP2850	0544-7061	1.58 - 1.98	40 - 50	39	990	10,750	4,890
RPP2851	0544-7064	1.98 - 2.37	50 - 60	39	990	10,750	4,890
RPP2852	0544-7067	2.38 - 2.77	60 - 70	47	1194	14,000	6,420
RPP2853	0544-7070	2.77 - 3.55	70 - 90	47	1194	14,000	6,420
RPP2854	0544-7073	3.55 - 4.33	90 - 110	47	1194	18,000	8,165

Extended Thimble Eye Heavy Duty Double Weave Stainless Steel Cable Grip

Part #	Stock Code	Range		Lattice Length		Eye Extension Length		Approx. Break Load	
		in	mm	in	mm	in	mm	lb	kg
RPP2870	0544-7076	0.39 - 0.60	10 - 15	20	500	20	350	2,295	1,040
RPP2871	0544-7079	0.60 - 0.80	15 - 20	20	500	20	350	2,903	1,315
RPP2872	0544-7082	0.80 - 0.99	20 - 25	20	500	20	350	4,590	2,082
RPP2873	0544-7085	1.0 - 1.19	25 - 30	20	500	20	350	5,468	2,480
RPP2874	0544-7088	1.20 - 1.58	30 - 40	20	500	20	350	7,898	3,582



## TOOLS, BUCKLES, AND BANDS FOR QUICK AND EFFICIENT BANDING OF CABLE GRIPS, HOSES, AND MORE.

Banding Tools deliver a fast and easy way to install banding clamps. These tools have a drop-forged construction and comfortable design that makes for fast and efficient installation of steel bands for cable grips, hoses, and many other applications.

Three different tool options are offered: fast, light duty, and heavy duty. See next page for the bands and buckles that are available for each.

### FAST • Banding Tool

Use with pre-looped, punch-style band or open-ended band

This tool uses pre-looped, punch-style bands for quick and secure banding of cable grips, hoses, and other cylindrical items.



RPP2875

### LIGHT DUTY • Banding Tool

For Utility Pole and other Light Duty Pole Banding applications

This tool has a built-in cutter with a PVC-coated handle for comfort and a sliding block assembly with spring-loaded lever. Operates on bandwidths 3/8" to 3/4" and thicknesses up to 0.030".



RPP8748

### HEAVY DUTY • Banding Tool

For Utility Pole and other Heavy Duty banding applications

This tool has a built-in cutter with a PVC-coated handle for comfort and a sliding block assembly with spring-loaded lever. Operates on bandwidths 3/4", 1", and 1-1/4" and thicknesses up to 0.044".

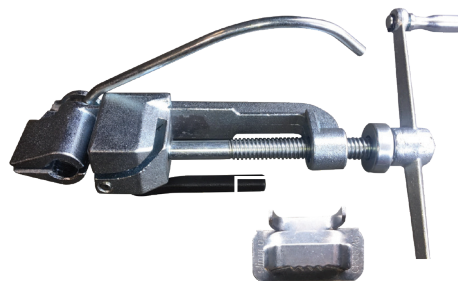

RPP8780

### Fast Banding: Pre-Looped Band and Open-Ended Band

#### Pre-Looped Band

Bands are pre-looped through the buckle to slide over the end of the item being banded. Use the Fast Banding Tool to tighten the band. When it's tight, punch the head of the tool and snip off the extra banding. The sizes refer to the inner loop diameter of the band. Select the size that will comfortably fit over the item being banded.

#### Open-Ended Band

Non pre-looped 201 SS 5/8" wide band with attached buckle. Includes punch-style buckle. Use as single loop for large diameters or as double loop for small diameters and added strength.

Banding Tool						
Part #	Stock Code	Description				
RPP2875	0544-7091	Standard punch-style banding tool.				
Pre-Looped Bands						
Part #	Stock Code	Width	Thickness	Loop Diameter	Pack Quantity	
RPP2876	0544-7094	3/8"	0.025"	13/16"	100/Box	
RPP2880	0544-7097	5/8"	0.030"	1"	100/Box	
RPP2879	0544-7100	5/8"	0.030"	1.5"	100/Box	
RPP2878	0544-7103	5/8"	0.030"	2.0"	100/Box	
RPP2877	0544-7106	5/8"	0.030"	2.5"	50/Box	
RPP8532	0544-7109	5/8"	0.030"	3.0"	50/Box	
Open-Ended Bands – 201 SS						
Part #	Stock Code	Width	Thickness	Length	Loop Diameter	Pack Quantity
RPP8596	0544-7112	5/8"	0.030"	24"	6" Single Wrap 3" Double Wrap	50/Box

### Light Duty Banding: Utility Pole and Other Light-Duty, Pole-Banding Applications

Use 3/4" wide 201 stainless steel or the 1/2" wide 316 stainless steel banding system to secure cables and other items to utility poles, light stands or other structures. The Light Duty Banding Tool allows you to easily tighten and secure any length band loop.

Rolls of 3/4" and 1/2" wide banding material are available in 100 ft. These 100 ft band rolls come in two convenient packages: standard, stack-and-store cardboard packaging or an easy-to-carry, red, plastic tote for the 3/4" and a blue, plastic tote for the 1/2".

Made of 201 stainless steel and 316 stainless steel, these buckles are used to secure 3/4" wide bands and 1/2" wide bands, respectively.



Banding Tool						
Part #	Stock Code	Description				
RPP8748	0544-7115	Operates on 3/8" to 3/4" band widths and 0.030" thickness. Tool has a built-in cutter with PVC coated handle for comfort and sliding block assembly with spring loaded lever.				
Bands						
Part #	Stock Code	Width	Thickness	Avg. Break Strength	Pack Quantity	Weight
RPP8743	0544-7118	3/4"	0.030"	2250 lb	100' roll - Cardboard Box	7.7 lb
RPP8744	0544-7121	3/4"	0.030"	2250 lb	100' roll - Red Plastic Tote	7.7 lb
RPP8325	0544-7124	1/2"	0.030"	1200 lb	100' roll - Cardboard Box	5.1 lb
RPP8326	0544-7127	1/2"	0.030"	1200 lb	100' roll - Blue Plastic Tote	5.9 lb
Buckles						
Part #	Stock Code	Width	Pack Quantity	Weight		
RPP8746	0544-7130	3/4"	100/Box	3.7 lb		
RPP8327	0544-7133	1/2"	100/Box	2.5 lb		

### Heavy Duty Banding: Utility Pole and Other Heavy-Duty, Pole-Banding Applications

Use 1-1/4" 201 stainless steel banding system to secure cables and other items to structures and poles where extra-strength hold is required. The Heavy Duty Banding Tool allows you to easily tighten and secure any length band loop.

Perfect for use with concrete utility poles, the extra width of this band provides a wider holding surface and stronger tensile strength than the 3/4" band. Useful in many application environments including utility, marine, and manufacturing where securely attaching cables, hoses, or tubes onto a cylindrical object is needed. 100 ft band roll comes in easy-to-stack-and-store cardboard box.

Banding Tool						
Part #	Stock Code	Description				
RPP8780	0544-7136	Operates on 3/4", 1", and 1-1/4" band widths and 0.044" thickness. Featuring a built-in cutter and a sliding block assembly.				
Bands						
Part #	Stock Code	Width	Thickness	Avg. Break Strength	Pack Quantity	Weight
RPP8745	0544-7139	1-1/4"	0.044"	5500 lb	100' roll - Cardboard Box	17.2 lb
Buckles						
Part #	Stock Code	Width	Pack Quantity	Weight		
RPP8747	0544-7142	1-1/4"	25/Box	3.2 lb		

REEL LIFTER



Reel Lifter is a high-capacity, compact unit that allows users in the utility construction industry to safely load, transport, and dispense wire and/or cable. It's also used in many industrial applications to make moving and relocating reels in a warehouse easy.

- Makes handling large cable reels quick and easy
- Has rugged construction to lift and upend reels
- Has easy rotation to unroll cable
- Counterweighted bottom arm for easy insertion in reel
- Side lifting eye allows reels to be put into a rolling or non-rolling position
- Repair kits available

Part #	Arbor Hole Min.	Arbor Hole Max.	Capacity	Weight	Length
	in	in	lb	lb	in
RPP08729	2	4	3,000	6.50	16 1/8
RPP09186	3	6	5,000	14.50	21 1/8

Reel Lifter Repair Kit			
Part #	Stock Code	Description	
RPP09708	0544-7151	3,000 lb factory repair kit with extension springs, cable assemblies, and all necessary pins for replacement of the interior cable system. Suitable for RPP08729.	
RPP09707	0544-7154	5,000 lb factory repair kit with extension springs, cable assemblies, and all necessary pins for replacement of the interior cable system. Suitable for RPP09186.	

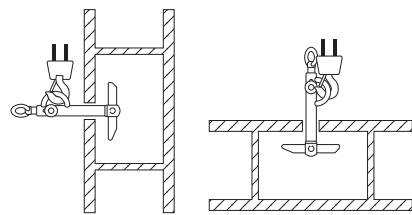

HAND LINE Tools



3" Hand Line Block

Hand Line Tools feature a 3" nylon fiberglass block with a safe, working-load limit of 1,000 lb and a double-locking snap with a safe, working-load limit of 5,000 lb. The 3" Hand Line Block's sheave can accommodate a 5/8" diameter rope and operates smoothly on the 1/2" diameter axle and swivel bearings. The side opening feature allows quick access to remove the hand line.

Part #	Stock Code	Description	Working Load Limit (lb)
RPPB8725	0544-7157	3" Hand Line Block	1,000
RPP18556	0544-7160	Double-Locking Snap	5,000

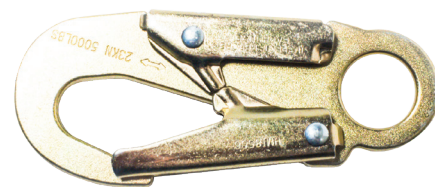

Double-Locking Snap Hook

60-TON HYDRAULIC Crimping Tools

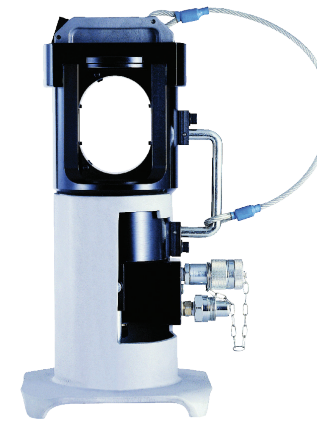

Hydraulic Crimping Tools are designed to crimp sleeves and lugs on ACSR and ACAR transmission and distribution cables using dies that meet the standards of the utility industry. Ideal for use in constructing substations and transmission lines.

The Single-Acting Crimping Tool uses hydraulic pressure to advance the ram into position, and an internal spring to return the ram to the original position. The Double-Acting Crimping Tool advances and returns the ram using hydraulic pressure alone, eliminating the possibility of the ram sticking or becoming jammed.

Hydraulic Crimping Tools are lightweight, portable, and come in a steel carrying case. These tools accept RPP S60 dies or any shell-type dies used with Alcoa or Burndy 60-ton crimping tools.

Part #	Stock Code	Tool Type	Crimp Force (Tons)	Operating Pressure
RPP7003	0544-7163	Single Action	60	10,000 PSI (700 bar)
RPP7018	0544-7166	Double Action	60	10,000 PSI (700 bar)

Steel carrying case includes Ground Stand Lifting Eye for hoist work.

Part #	Stock Code	RPP Ref.	Alcoa Equiv.
RPP7067	0475-9119	S60-10SH	6010SH
RPP7068	0475-9122	S60-12SH	6012SH
RPP7069	0475-9125	S60-14SH	6014SH
RPP7070	0475-9128	S60-16SH	6016SH
RPP7071	0544-6332	S60-18SH	6018SH
RPP7072	0544-6335	S60-20SH	6020SH
RPP7073	0544-6338	S60-24SH	6024SH
RPP7074	0544-6341	S60-27SH	6027SH

Part #	Stock Code	RPP Ref.	Alcoa Equiv.
RPP7075	0544-6344	S60-30SH	6030SH
RPP7076	0544-6443	S60-34SH	6034SH
RPP7077	0544-6446	S60-36SH	6036SH
RPP7078	0544-6449	S60-38SH	6038SH

Part #	Stock Code	RPP Ref.	Alcoa Equiv.
RPP7083	0544-6464	S60-40AH	6040AH
RPP7084	0544-6467	S60-44AH	6044AH
RPP7085	0544-6470	S60-48AH	6048AH
RPP7086	0544-6473	S60-52AH	6052AH
RPP7087	0544-6410	S60-07CD	6007CD
RPP7088	0544-6413	S60-08CD	6008CD
RPP7089	0544-6416	S60-09CD	6009CD
RPP7090	0544-6419	S60-10CD	6010CD

MECHANICAL Crimping Tools



Mechanical Crimping Tools complete the variety of utility distribution service connections that need to be made on the line, pole, and home. These tools have been designed to provide reliable crimps installing full-tension or non-tension connectors.

Mechanical Crimping Tool's D3 groove allows W-die inserts for installing taps, splices, and terminal connectors. W-die inserts lock securely and easily into place with the positive lock, spring-loaded die buttons. RPP also offers a Mechanical Crimping Tool that accepts Kearney-type dies. These tools have ergonomic handles for comfortable use and maximum leverage when making critical connections.

Part #	Stock Code	Tool Type	Crimp Force (lb)	Length (in)	Weight (lb)
RPP7002	0544-7181	O&D	9,000	25.75	7
RPP7004	0544-7184	BG&D	9,000	25.75	7
RPP08732	0544-7187	5/8 Nose Die & Kearney Seat (Accepts 'Kearney' type)	9,000	25.75	7

RPP W-Die Sets (D3 Insert)

Part #	Stock Code	RPP Ref.	Burndy Equiv.
RPP7020	0544-7190	S6-K840	WK840
RPP7021	0544-7544	S6-BG	WBG
RPP7022	0544-7193	S6-O	WO

Part #	Stock Code	RPP Ref.	Burndy Equiv.
RPP7023	0544-7196	S6-247	W247
RPP7024	0544-7199	S6-249	W249



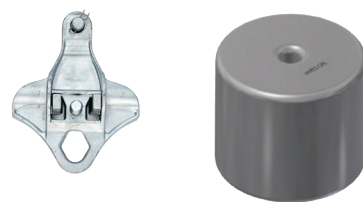

### POLE LINE SUSPENSION CLAMPS

Pole Line Suspension Clamps provide a safe, quick installation and removal of the conductor when attached to the insulator. A single fastener fully opens and closes the jaw. The clamps come in a variety of sizes to accommodate conductors from 0.16" to 1.50" diameter, and loadings of up to 18,000 lb.

To prevent loss, all moving parts of the clamps are captive. Depending on size, the clamps are either made from heat-treated aluminum alloy 356-T6 or ductile iron 60-45-15 and hot-dip galvanized for corrosion resistance.

### CABLE PULLING GRIPS AND CABLE SUPPORT GRIPS

#### ASSESSMENT OF SUITABILITY

Many factors must be taken into account when assessing the suitability of a cable grip for a proposed application and trying to calculate a safe working load.

#### These include:

- Size of cable grip in relation to size/shape of gripped object(s)
- Stability of object(s) when gripped
- Grip surface of object(s)
- Resistive force of object(s)
- Anticipated path of movement, including possible obstructions
- Approximate breaking strength of cable grip
- Condition of cable grip
- Suitability and compatibility of any attachments used
- Environment / operating conditions
- Persons at risk

If you have any questions regarding suitability for any particular application please call 772.408.5211.

**PLEASE NOTE:** Cable grips must be double-steel banded securely before being pulled.

#### LATTICE DIMENSIONS

Lattice dimensions shown are fitted to a nominal diameter of cable. Free length may be slightly longer than stated.

#### APPROXIMATE BREAK LOAD

This is the calculated average based on actual testing done. Approximate Break Loads are quoted as a guide only.

#### SAFE WORKING LOAD

Application Load is normally calculated to be reduced by, at least, a factor of 5x the Approximate Break Load. Due to the wide variety of application parameters, apply a sensible safety factor to suit the safety requirements for the conditions of use.

The Safe Working Load (SWL) of a cable grip will depend on the Factor of Safety (FOS) applied to the Minimum Breaking Load.

#### FACTOR OF SAFETY (FOS)

Where the operational risk is considered to be normal, it is recommended that a FoS of 5 be applied. For a high-risk operation, a FoS of, at least, 10 should be considered. It is impossible to catalog or guarantee a safety factor that will apply for all applications.

Approximate Break Loads stated on any certification, the recommended FoS, and any implied or stated fitness for purpose, are all only applicable when the cable grip is new and unused.

A 20% variance in break loads must be allowed when selecting a cable grip. A suitable swivel must be used if there is a twist in the cable.

Pulling devices should only be attached via the pulling eye.

Torsional stress must be dealt with when using cable grips for line pulls and wire splices. When twisting forces are present, use a swivel that rotates under load to release torsional stress.

#### CABLE GRIP

#### SAFETY INFORMATION

- Ensure that the cable grip mesh fits the conductor correctly
- Ensure that the conductor fits up to the midpoint of the protective shoulder
- Clamp the ends of the cable grip when attaching the conductor. Between 1 ¼" and 2 ¼" from the end of the cable grips is recommended. Secure clamping must be used on cable grips
- Never modify or attempt to repair any cable grip
- Check the condition of the cable grip and ensure that it's the correct size for the intended application. Do not exceed the rated capacity
- Cable grips that are worn, bent, or damaged should not be used
- Cable grips are only to be used for temporary applications
- Pulling devices should only be attached via the pulling eye
- Cable grips should only be fitted and used by trained parties
- Ensure proper maintenance of cable grips. Contact 772.408.5211 for assistance



RPP CABLE GRIPS MUST NOT BE USED TO THEIR APPROXIMATE BREAKING STRENGTH. A SENSIBLE SAFETY FACTOR MUST ALWAYS BE USED. IF IN DOUBT CONTACT 772.408.5211.

#### TYPICAL CONFIGURATIONS

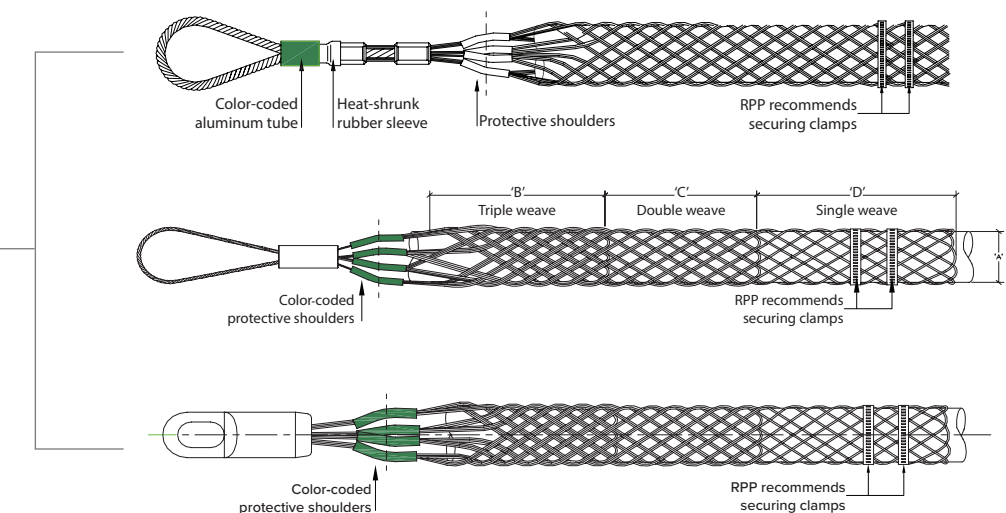

## SINGLE AND DOUBLE EYE CABLE GRIP INSTALLATION INSTRUCTIONS

**PLEASE NOTE:** The condition of the cable grip should always be checked prior to use. The correct size of grip should always be used for the intended application. The rated capacity of the grip should never be exceeded. Grips that are worn, bent, or otherwise damaged should not be used.



1. Select the correct grip for the diameter of the conductor.

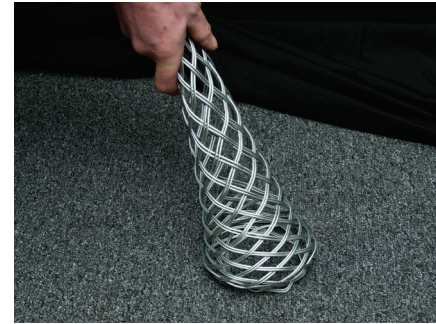

2. Prior to use, the lattice at the end of the grip needs to be widened. This can be easily achieved by pressing the end of the grip against a hard surface, which causes the lattice to expand.

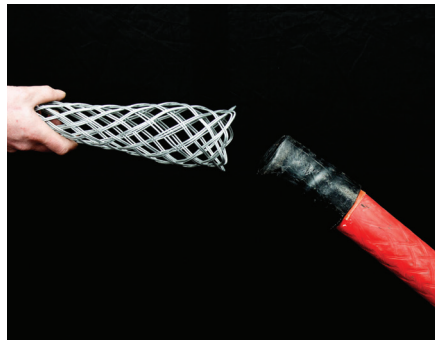

3. The grip should then be placed over the end of the conductor...



4. ...and pushed over the conductor.



5. The grip then needs to be pushed along so that all the lattice is in contact with the conductor.



6. Once the cable grip is in place on the conductor, two clamps should be fitted to the end of the grip (as shown). We recommend between 1 1/4" (30mm) and 2 1/4" (55mm) away from the end of the cable grip.



7. Tape should then be wound around the end of the cable grip furthest away from the eye ends.



8. This will prevent the cable grip from snagging when in use.

## LACE UP CABLE GRIP INSTALLATION INSTRUCTIONS

**PLEASE NOTE:** The images shown here use Double Weave Cable Grips. When lacing Single Weave Cable Grips please use single wire lace; use double-laced for double weave cable grips; and use triple-laced for Triple Weave Cable Grips.



1. Start the lacing from the 'eye' end or anchoring end of the cable grip.



2. Thread the lace through the first two loops of the split and pull through until the laces are centered at this point.



3. Don't pull the lace too tight at this stage. Leave a space between adjoining loops roughly equal to the width of one diamond of the mesh.



4. Continue down the length of the cable grip. Try to maintain equal tension and equal spacing throughout as this leads to a more stable and equal grip.



5. As you continue down the length, pull the open sides of the grip as wide apart as required.



6. Try to achieve an even and neat lace-up as this assists with the strength of the grip when pulling.



7. Finally, tie the ends of the lace once or twice around the end of the cable grip, twisting the ends together securely. Excess lace can be cut off.

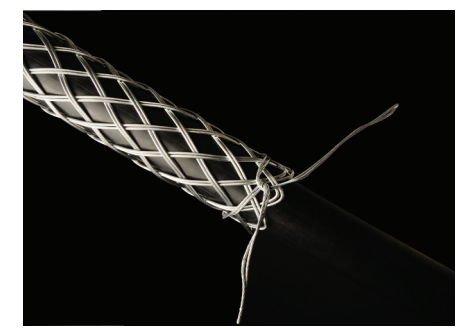

8. Add any additional support as required - banding is recommended. The RPP cable grip is now ready to use.



# CONTACT US TODAY!

## 772-408-5211

RPP has a diverse offering of cord and cable complemented with a wide selection of switches, receptacles, sensors, and controls. Its product portfolio allows RPP to provide the necessary device and high-quality wire for any application.



## RPP Offers Many Solution-Based Products Check Out Our Complete Portfolio



### WIRING DEVICES

- Lampholders
- Locking Devices
- Plugs & Connectors
- Power Devices
- Power Strips
- Straight Blade Receptacles
- Switches
- USB Charger Devices
- Voice/Data/Video
- Wall Plates

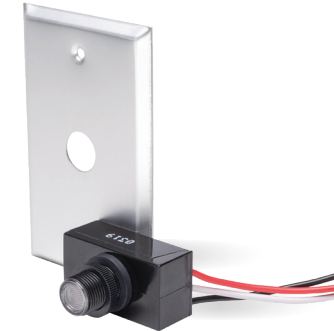

### CONTROLS

- Dimmers
- Fan Controls
- In-Wall Timers
- Photocontrols



### WIRE/CABLE

- Coaxial Cable
- Data Cable
- Landscape Cable
- Fire Alarm Cable
- Security Cable
- Speaker Cable
- Thermostat Wire



### CORD

- Appliance
- Charging Cables
- Dryer
- Generator
- HDMI
- Portable
- Range



### WEATHERPROOF COVERS

- Expandable In-Use
- Metallic
- Residential In-Use
- Standard In-Use



### OCCUPANCY SENSORS

- Passive Infrared
- Dual-Tech
- Ceiling Mount
- Switch Mount



[www.RPP-USA.com](http://www.RPP-USA.com)

All our products are available exclusively  
at City Electric Supply.

Visit [www.cityelectricsupply.com](http://www.cityelectricsupply.com) to find a branch near you.



**11675 TOM MACKIE BLVD.**  
PORT ST. LUCIE, FL 34987  
P. 772.408.5211

[www.TAMCOGROUP.com](http://www.TAMCOGROUP.com)

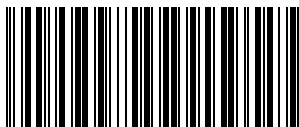

0545-5143

*Printed in* **USA** 